

FILED

MAR 12 2013

BY  DEPUTY
REGISTRAR OF VOTERS

RESOLUTION NO. 2012/13-27

RESOLUTION OF THE BOARD OF TRUSTEES OF THE HESPERIA UNIFIED SCHOOL DISTRICT DETERMINING THE VALIDITY OF PRIOR PROCEEDINGS, ESTABLISHING COMMUNITY FACILITIES DISTRICT NO. 2013-1, AUTHORIZING THE LEVY OF A SPECIAL TAX WITHIN COMMUNITY FACILITIES DISTRICT NO. 2013-1, ESTABLISHING AN APPROPRIATIONS LIMIT, MAKING CERTAIN FINDINGS, CALLING AN ELECTION AND TAKING RELATED ACTIONS

WHEREAS, the Board of Trustees (“Board”) of the Hesperia Unified School District (“District”), has heretofore adopted Resolution No. 2012/13-21 stating its intention to form Community Facilities District No. 2013-1 of the District pursuant to the provisions of the Mello-Roos Community Facilities Act of 1982, as amended (“Act”); and

WHEREAS, a copy of Resolution No. 2012/13-21, setting forth a description of the proposed boundaries of Community Facilities District No. 2013-1, the facilities to be provided, the cost of providing such facilities and the proposed rate and method of apportionment of the special tax to be levied within Community Facilities District No. 2013-1 to finance the facilities and other costs, including payment of the principal and interest on bonds or other securities proposed to be authorized within Community Facilities District No. 2013-1, is on file with the Clerk of the Board and is incorporated herein by this reference; and

WHEREAS, pursuant to the directives of Resolution No. 2012/13-23 a copy of the proposed boundary map of Community Facilities District No. 2013-1 was recorded in the office of the County Recorder of the County of San Bernardino, State of California, on February 13, 2013, as Instrument No. 2013-0065558, Book No. 85, Pages 55-58, inclusive, in the Books of Assessment and Community Facilities District Maps in such office, in compliance with Section 3110, *et seq.*, of the Streets and Highways Code of the State of California and the Act; and

WHEREAS, notice of the public hearing was posted and published as required by the Act; and

WHEREAS, on March 4, 2013, the Board adopted Resolution No. 2012/13-26, ordering certain changes to the Rate and Method of Apportionment of Special Taxes as adopted by Resolution No. 2012/13-21 (“RMA”), and adoption of a proposed First Amended Rate and Method of Apportionment of Special Taxes of CFD No. 2013-1 (“First Amended Rate and Method”) which replaces the RMA for all purposes relating to the proceedings of CFD No. 2013-1; and

WHEREAS, pursuant to the requirements of the Act, applicable State of California law and the provisions of Resolution No. 2012/13-21, the District has completed related postings,

filings and provision of notices, which have been described to the Board and confirmation of which is on file with the Clerk of the Board; and

WHEREAS, on March 4, 2013, pursuant to the provisions of the Act, the Board conducted and completed the public hearing on the formation of proposed Community Facilities District No. 2013-1 and the proposed special tax authorization, and other related matters; and

WHEREAS, during such public hearing all persons desiring to be heard on all matters pertaining to the formation of Community Facilities District No. 2013-1 were heard and a full and fair hearing was held; and

WHEREAS, at such public hearing a community facilities district report ("Report") containing a brief description of the public facilities by type which will be required to meet the needs of the territory within Community Facilities District No. 2013-1 and the estimated cost of providing those facilities was presented to, and considered by, the Board; and

WHEREAS, the Board has been provided with information relating to the number of registered voters within the boundaries of proposed Community Facilities District No. 2013-1.

NOW, THEREFORE, THE BOARD OF TRUSTEES OF THE HESPERIA UNIFIED SCHOOL DISTRICT DOES HEREBY RESOLVE, DETERMINE AND ORDER AS FOLLOWS:

Section 1. The foregoing recitals are true and correct and are hereby incorporated herein by this reference.

Section 2. Pursuant to Section 53325.1(b) of the Act, the Board finds and determines that the proceedings conducted prior hereto were valid and in conformity with the requirements of the Act including, but not by way of limitation, the following:

Adoption by the Board of a Resolution of Intention to establish such Community Facilities District (Resolution No. 2012/13-21), a Resolution of Intention for said Community Facilities District to incur bonded indebtedness (Resolution No. 2012/13-22) and a Resolution approving the boundary map of such Community Facilities District (Resolution No. 2012/13-23); publication and posting of the notices of the hearings on the establishment of Community Facilities District No. 2013-1, the authorization of special taxes and proposed incurring of bonded indebtedness; filing of the Resolution of Intention with the City of Victorville; recording of the proposed boundary map of CFD No. 2013-1 in the office of the County Recorder for the County of San Bernardino, State of California, pursuant to Section 3110, *et seq.*, of the Streets and Highways Code of the State of California; the adoption of Resolution No. 2012/13-26 providing for an amendment to the proposed RMA of the Special Tax of Community Facilities District No. 2013-1; the holding, conducting, and completing of the public hearing on the establishment of Community Facilities District No. 2013-1, at

which time, the Board received the Report, as ordered by the Board, and at which time all interested parties and taxpayers were permitted to protest against the establishment of Community Facilities District No. 2013-1, the First Amended Rate and Method, the proposed special taxes, as amended, the intention to incur bonded indebtedness and the furnishing of the proposed public facilities.

Section 3. The Report, prepared pursuant to the Act, as previously reviewed as a part of the public hearing process and made a part of the record of the hearing, is hereby approved and is ordered to be kept on file with the record of these proceedings and available for public inspection.

Section 4. The Board finds that the public convenience and necessity require the facilities proposed to be funded through Community Facilities District No. 2013-1.

Section 5. A community facilities district to be named the “**Community Facilities District No. 2013-1 of the Hesperia Unified School District**” (“CFD No. 2013-1”) is hereby established pursuant to the Act for the territory shown on Exhibit “A,” which is attached hereto and incorporated herein by this reference.

Section 6. The type of public facilities proposed to be provided within CFD No. 2013-1 are described in Exhibit “B” attached hereto, and incorporated herein by this reference, and are also described within the Report (hereinafter the “Facilities”). Pursuant to Government Code Section 53313.5, the Board hereby finds that the existing Facilities which may be purchased or refinanced with funds of proposed CFD No. 2013-1 were constructed under the direction, supervision and legal requirements applicable to the District at the time such were designed, constructed, acquired and/or completed.

Section 7. For all funds needed to accomplish the herein described actions, it is the intention of the District to levy annually, in accordance with the procedures contained in the Act, a special tax sufficient to pay for the design, acquisition, construction and/or completion of the Facilities, and/or to pay the principal and interest and other periodic costs on securities which may be issued to finance the Facilities; any installment purchase payments or lease payments for or related to the Facilities; and all incidental expenses including: the cost of planning, designing, constructing, acquisition, relocation and rehabilitation of the Facilities to be financed pursuant to the Act, including, but not limited to, the cost of environmental evaluations of the Facilities; the costs associated with the creation of CFD No. 2013-1, issuance of bonds or other securities, determination of the amount of taxes, collection of special taxes or other revenues, payment of taxes, or costs otherwise incurred in order to carry out the authorized purposes of CFD No. 2013-1; and any other expenses incidental to the construction, acquisition, relocation, rehabilitation, completion and/or inspection of the Facilities including all costs incidental to, or connected with, the accomplishment of the purposes for which debt may be incurred, including, but not limited to, the estimated costs of construction or acquisition of buildings, or both; costs of acquisition of real property; satisfaction of contractual obligations relating to the unfunded obligations of the developed property of Community Facilities District No. 2004-1 of the District (“CFD No. 2004-1”) as well as contractual obligations relating to expenses or the advancement of funds for

expenses existing at the time bonds or other debt or securities are issued pursuant to the Act; architectural, engineering, inspection, legal, fiscal, and financial consultant fees; reserve funds; discount fees; interest on any securities of CFD No. 2013-1 due and payable prior to the expiration of one (1) year from the date of completion of the Facilities, not to exceed twenty-four (24) months from the date of issuance of the securities; election costs; and all costs of issuance of securities, including, but not limited to, fees for special counsel and legal counsel, costs of obtaining credit ratings, insurance premiums, fees for letters of credit, tax surety bonds, and/or other credit enhancement costs, and printing costs. Special tax revenues of CFD No. 2013-1 may also be used to pay debt service on existing obligations issued in order to finance some or all of the Facilities, including, but not limited to, bonded indebtedness of CFD No. 2004-1. The Board also reserves the right to establish a fund, and use tax revenues, pursuant to Section 53314.5 of the Act.

As herein provided, CFD No. 2013-1 may also, in lieu of issuing bonds, issue or execute and deliver equivalent securities, including, but not limited to, lease-revenue bonds, revenue securities or certificates of participation, which may involve a lease-purchase financing arrangement for property and/or facilities with a nonprofit public benefit corporation or a joint powers agency and may involve a pledge of some or all of the special taxes levied and collected within CFD No. 2013-1 to pay principal, interest and redemption costs on such obligation(s).

Section 8. The First Amended Rate and Method of the special taxes to be levied within CFD No. 2013-1 is described in detail in Exhibit "C" attached hereto and made a part hereof. The special tax is based upon the benefit received by parcels of real property within CFD No. 2013-1 derived from the right to use the Facilities necessitated by development in such area. The special tax is further based upon the cost of making the Facilities available to each parcel in the area. The special tax is apportioned to each parcel on the foregoing basis pursuant to Section 53325.3 of the Act and such special tax is not based upon the ownership of real property.

Special taxes shall not be levied and collected with respect to any parcel that is exempt from special taxes pursuant to the First Amended Rate and Method or for which the special tax obligation has been fully prepaid and a notice of cessation of special taxes recorded.

Any special taxes collected pursuant to the authorization of the qualified electors shall be collected for a period not to exceed thirty (30) years from the first fiscal year in which special taxes are levied (as further set forth in the First Amended Rate and Method).

Under no circumstances will the special tax levied in any fiscal year against any parcel subject to special taxes and used for private residential purposes, as defined in Government Code Section 53321, be increased as a consequence of delinquency or default by the owner of any other parcel or parcels within proposed CFD No. 2013-1 by more than ten percent (10%) above the amount that would have been levied in such fiscal year had there not been such delinquencies or defaults.

Section 9. It is the intention of the Board that owners of parcels within CFD No. 2013-1 may prepay the special tax obligation to CFD No. 2013-1 for such parcel(s) by those method(s) as set forth in the First Amended Rate and Method.

Section 10. In the event that a portion of the property within CFD No. 2013-1 shall become for any reason exempt, wholly or partially, from the levy of the special tax specified in Exhibit "C," the Board shall, on behalf of CFD No. 2013-1, increase the levy to the extent necessary, and as permitted by statute, up to the authorized maximum tax, upon the remaining property within CFD No. 2013-1 which is not exempt in order to yield the required debt service payments or other payments for which such special tax revenues, may have been, or are, committed or pledged.

Section 11. Written protests against the formation of CFD No. 2013-1, the proposed territory to be included within CFD No. 2013-1 or the proposed facilities to be furnished or financed through CFD No. 2013-1 have not been filed by fifty-percent (50%) or more of the registered voters or property owners of one-half (2) or more of the area of land within CFD No. 2013-1.

Section 12. The special taxes proposed to be levied in CFD No. 2013-1 to pay for the proposed Facilities have not been eliminated by protest by fifty-percent (50%) or more of the registered voters residing within the territory of CFD No. 2013-1 or the owners of one-half (2) or more of the area of land within CFD No. 2013-1.

Section 13. A special election is hereby called and ordered for CFD No. 2013-1 on the proposition of levying special taxes on property within CFD No. 2013-1 as set forth below. This Resolution shall constitute the election order for such special election.

Section 14. The Board, on behalf of CFD No. 2013-1 hereby submits to the qualified electors of CFD No. 2013-1 a proposition to establish an annual appropriations limit as defined by subdivision (h) of Section 8 of Article XIII B of the California Constitution, for CFD No. 2013-1. Such annual appropriations limit shall be equal to the amount of the proposed amount of bonded indebtedness to be authorized for CFD No. 2013-1 subject to adjustment as set forth in Government Code Section 53325.7. The proposition to establish an appropriations limit shall be combined, pursuant to Government Code Section 53353.5 of the Act, with the proposition relating to the levy of a special tax, and the proposition to incur bonded indebtedness, the combined form of such measure is set forth in Exhibit "D," attached hereto and incorporated herein by this reference.

Section 15. The Board hereby calls and orders, on behalf of CFD No. 2013-1, a combined mail-in ballot for the CFD No. 2013-1 election on the proposition of levying special taxes on property within CFD No. 2013-1 and shall be consolidated with the election of CFD No. 2013-1 on the proposition of incurring bonded indebtedness pursuant to Section 53353.5 of the Act. The proposed proposition relative to incurring indebtedness in the maximum principal aggregate amount of \$2,750,000 within CFD No. 2013-1, and the First Amended Rate and Method and the proposition to establish an annual appropriations limit shall be submitted to the

qualified electors on one (1) ballot pursuant to Section 53353.5 of the Act. The form of the combined measure for such election is set forth in Exhibit "D," attached hereto and incorporated herein by this reference.

Section 16. Pursuant to Section 53326 of the Act and documents furnished to the Board, the Board hereby determines that there are twelve (12) registered voters or more within CFD No. 2013-1. Pursuant to Section 53326(b) of the Act, the Board hereby determines and directs that the election shall be a registered voter election with each registered voter having one (1) vote.

Section 17. The date of the election for CFD No. 2013-1 on the combined election propositions as set forth herein shall be on _____, 2013.

Section 18. Pursuant to the provisions of Section 53327(b) of the Act, the Board hereby confirms and directs that the San Bernardino County Registrar of Voters shall be the election official ("Election Official") for this election ("Election"). Pursuant to Section 53326(d) of the Act, the Election Official shall conduct the Election by mail-in ballot. The Election Official is authorized to, and shall, take all actions necessary to conduct the Election as provided for herein.

Section 19. A tax rate statement, as required by Elections Code Sections 9400-9404, shall be furnished to the qualified electors. The District staff and consultants are hereby authorized to assist in the preparation of such tax statement.

Section 20. Pursuant to the requirements and provisions of Government Code Section 50075.1, the Board hereby finds, determines and directs as follows:

(a) The special taxes to be authorized at the Election shall be used only as set forth in Resolution No. 2012/13-21 and as authorized by the Act and the First Amended Rate and Method, which is incorporated herein by this reference.

(b) All special taxes so levied and collected within CFD No. 2013-1 shall be used only for the above-referenced purposes.

(c) The District staff is directed to create a fund or account, which may include sub-accounts, in which the special taxes levied and collected within CFD No. 2013-1 shall be deposited. Such fund(s) and/or account(s) may, at the appropriate time, be combined or merged with funds, accounts and subaccounts created and used to pay debt service and for other purposes in connection with outstanding bonds of CFD No. 2004-1, or outstanding bonds or other securities, issued by, or on behalf of, CFD No. 2013-1 to finance or refinance the Facilities as further described herein (collectively referred to herein as the "Bonds").

(d) The District's Chief Financial Officer, or such other officer(s) as shall be designated by the District's Superintendent, on behalf of CFD No. 2013-1, shall have the

responsibility, no less often than annually, to provide the Board with a written report which shall contain at least the following information:

- (i) the amount of special taxes collected within CFD No. 2013-1 and expended for an identified period, which may be quarterly, semi-annually or annually; and
- (ii) a brief discussion of the status of the acquisition, construction or financing of the Facilities with the above-referenced special taxes.

The report required by this Section 20(d) may be combined with other periodic reports which include the same information, including, but not limited to, periodic reports made to the California Debt and Investment Advisory Commission (CDIAC), continuing disclosure reports provided in connection with the outstanding Bonds and/or those reports required under Section 20(d) of this Resolution. Reports shall be prepared for each year in which special taxes are levied and collected within CFD No. 2013-1.

The provisions of this Section 20 shall cease and terminate upon the earliest of any of the following events:

- (i) the dissolution of CFD No. 2013-1;
- (ii) the recordation of a Notice of Cessation of Special Taxes for all of the territory within CFD No. 2013-1; or
- (iii) the final year in which special taxes may be collected within CFD No. 2013-1 pursuant to the provisions of the First Amended Rate and Method.

Section 21. The Clerk of the Board, District officers and staff and District consultants are hereby directed to take all necessary and appropriate action(s) as may be required by the Election Official to assist in the conduct of the Election referenced herein and to carry out the directives of this Resolution.

Section 22. The Board hereby directs that the Interim Superintendent of the District and the District staff, or at the discretion of the District, a hired consultant, will be responsible for preparing annually, a current roll of special tax levy obligations by assessor parcel number and will be responsible for estimating future tax levies in CFD No. 2013-1 pursuant to Section 53340.2 of the Act. The District staff may be reached at 15576 Main Street, Hesperia, California 92345, telephone (760) 244-4411.

Section 23. Upon recordation of the Notice of Special Tax Lien pursuant to Section 3114.5 of the Streets and Highways Code of the State of California, a continuing lien to secure each levy of the special tax shall attach to all nonexempt real property within CFD No. 2013-1 and this lien shall continue in full force and effect until the special tax obligation is prepaid and

permanently satisfied and the lien canceled in accordance with law or until collection of the authorized special tax by the Board, acting as the legislative body of CFD No. 2013-1, ceases.

Section 24. A seal consisting of two concentric circles with the name "Community Facilities District No. 2013-1 of the Hesperia Unified School District" imprinted between such circles and the words "Formed March 4, 2013" imprinted in the center thereof, is hereby approved as the official seal of CFD No. 2013-1.

Section 25. The regular meetings of CFD No. 2013-1 shall coincide with the times, dates and location of the regular meetings of the Board.

Section 26. If any term, finding, condition, directive or other provision of this Resolution (each a "Provision") or any proceeding undertaken in connection with the formation of CFD No. 2013-1, the authorization of the special taxes or Bonds, or any matter related thereto (each a "Proceeding") is duly held, to any extent, to be invalid or unenforceable, no other Provision or Proceeding shall be affected by such holding, and each such other Provision and Proceeding shall be valid and enforceable to the fullest extent provided by law. If any Provision or Proceeding is duly held to be partially invalid or unenforceable, no other portion of such Provision or Proceeding shall be affected by such holding and each other portion of such Provision or Proceeding shall continue to be valid and enforceable to the fullest extent provided by law. If any Provision or Proceeding is duly held, to any extent, to be invalid or unenforceable with respect to any particular property within CFD No. 2013-1, such Provision or Proceeding shall continue to be valid and enforceable to the fullest extent provided by law with respect to all other property within CFD No. 2013-1. If any Provision or Proceeding is duly held, to any extent, to be invalid or unenforceable with respect to any particular person or entity, such Provision or Proceeding shall continue to be valid and enforceable to the fullest extent provided by law with respect to every other person or entity.

ADOPTED, SIGNED AND APPROVED this 4th day of March, 2013.

HESPERIA UNIFIED SCHOOL DISTRICT:

By: Ella M. "Lu" Rogers
President, Board of Trustees of the Hesperia
Unified School District

By: Doreen Child
Clerk, Board of Trustees of the Hesperia
Unified School District

STATE OF CALIFORNIA)
) ss.
COUNTY OF SAN BERNARDINO)

I, Niccole Childs, Clerk of the Board of Trustees of the Hesperia Unified School District, do hereby certify that the foregoing Resolution was adopted by the Board of Trustees of said District at a meeting of said Board held on the 4th day of March, 2013, and that it was so adopted by the following vote:

AYES: 5

NOES: 0

ABSTAIN: 0

ABSENT: 0



Clerk of the Board of Trustees of the Hesperia
Unified School District

STATE OF CALIFORNIA)
) ss.
COUNTY OF SAN BERNARDINO)

I, Niccole Childs, Clerk of the Board of Trustees of the Hesperia Unified School District, do hereby certify that the foregoing is a full, true and correct copy of Resolution No. 2012/13-27 of said Board, and that the same has not been rescinded, amended or repealed.

Dated this 4th day of March, 2013.

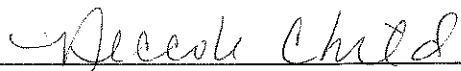

Clerk of the Board of Trustees of the Hesperia
Unified School District

EXHIBIT "A"
BOUNDARY MAP OF
CFD NO. 2013-1

PROPOSED BOUNDARIES OF
 HESPERIA UNIFIED SCHOOL DISTRICT
 COMMUNITY FACILITIES DISTRICT NO. 2013-1
 COUNTY OF SAN BERNARDINO
 STATE OF CALIFORNIA

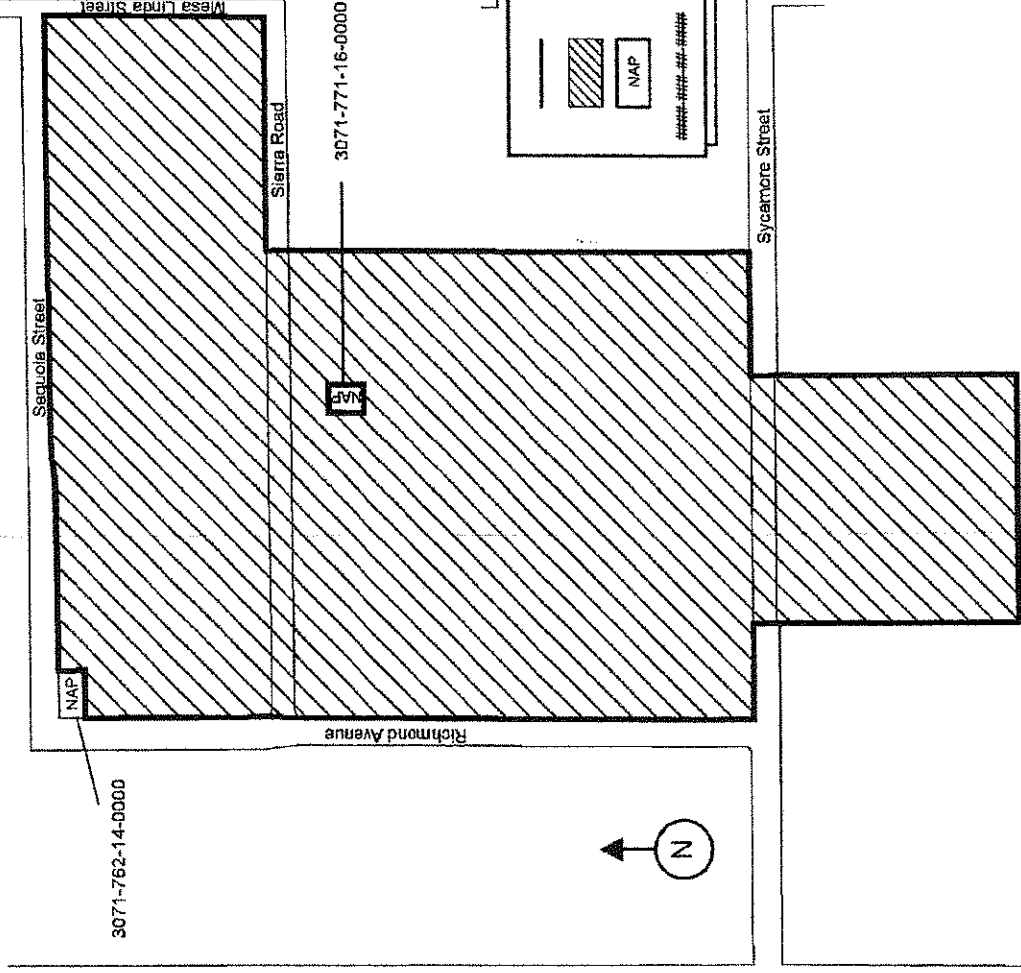

LEGEND

- Boundaries of Community Facilities District No. 2013-1 Exhibit A
- Not a part of the Community Facilities District
- Assessor's Parcel Number

Hesperia Unified School District Clerk of the Board of Trustees Filing Certificate

(1) Filed in the office of the Clerk of the Board of Trustees of the Hesperia Unified School District this 12 day of Feb., 2013

Anacle Childs
 Clerk of the Board of Trustees of the Hesperia Unified School District

(2) I hereby certify that the within map showing the boundaries of Community Facilities District No. 2013-1, County of San Bernardino, State of California, was approved by the Board of Trustees of the Hesperia Unified School District at a regular meeting thereof, held on this 22nd day of Feb., 2013 by its Resolution No. 2013-23

Anacle Childs
 Clerk of the Board of Trustees of the Hesperia Unified School District

San Bernardino County Recorder's Certificate
 Filed this 13th day of February, 2013 at the hour of 2 o'clock P.M.
 in Book 83 of Maps of Assessment and Community Facilities Districts at Page 55-58 in the office of the County Recorder in the County of San Bernardino, State of California.

Dennis Draeger
 Assessor-Recorder-Clerk
 County of San Bernardino

Reference is hereby made to the Assessor maps of the County of San Bernardino for an exact description of the lines and dimensions of each lot and parcel

Doc # 2013-006558

EXHIBIT "A"
 PROPOSED ASSESSOR'S PARCELS
 COMMUNITY FACILITIES DISTRICT NO. 2013-1
 HESPERIA UNIFIED SCHOOL DISTRICT
 COUNTY OF SAN BERNARDINO
 STATE OF CALIFORNIA

Assessor's Parcel Numbers

3071-751-01-0000	3071-751-28-0000	3071-751-55-0000	3071-761-19-0000	3071-762-10-0000
3071-751-02-0000	3071-751-29-0000	3071-751-56-0000	3071-761-20-0000	3071-762-11-0000
3071-751-03-0000	3071-751-30-0000	3071-751-57-0000	3071-761-21-0000	3071-762-12-0000
3071-751-04-0000	3071-751-31-0000	3071-751-58-0000	3071-761-22-0000	3071-762-13-0000
3071-751-05-0000	3071-751-32-0000	3071-751-59-0000	3071-761-23-0000	3071-762-15-0000
3071-751-06-0000	3071-751-33-0000	3071-751-60-0000	3071-761-24-0000	3071-762-16-0000
3071-751-07-0000	3071-751-34-0000	3071-751-61-0000	3071-761-25-0000	3071-762-17-0000
3071-751-08-0000	3071-751-35-0000	3071-751-62-0000	3071-761-26-0000	3071-762-18-0000
3071-751-09-0000	3071-751-36-0000	3071-751-63-0000	3071-761-27-0000	3071-771-01-0000
3071-751-10-0000	3071-751-37-0000	3071-761-01-0000	3071-761-28-0000	3071-771-02-0000
3071-751-11-0000	3071-751-38-0000	3071-761-02-0000	3071-761-29-0000	3071-771-03-0000
3071-751-12-0000	3071-751-39-0000	3071-761-03-0000	3071-761-30-0000	3071-771-04-0000
3071-751-13-0000	3071-751-40-0000	3071-761-04-0000	3071-761-31-0000	3071-771-05-0000
3071-751-14-0000	3071-751-41-0000	3071-761-05-0000	3071-761-32-0000	3071-771-06-0000
3071-751-15-0000	3071-751-42-0000	3071-761-06-0000	3071-761-33-0000	3071-771-07-0000
3071-751-16-0000	3071-751-43-0000	3071-761-07-0000	3071-761-34-0000	3071-771-08-0000
3071-751-17-0000	3071-751-44-0000	3071-761-08-0000	3071-761-35-0000	3071-771-09-0000
3071-751-18-0000	3071-751-45-0000	3071-761-09-0000	3071-761-36-0000	3071-771-10-0000
3071-751-19-0000	3071-751-46-0000	3071-761-10-0000	3071-762-01-0000	3071-771-11-0000
3071-751-20-0000	3071-751-47-0000	3071-761-11-0000	3071-762-02-0000	3071-771-12-0000
3071-751-21-0000	3071-751-48-0000	3071-761-12-0000	3071-762-03-0000	3071-771-13-0000
3071-751-22-0000	3071-751-49-0000	3071-761-13-0000	3071-762-04-0000	3071-771-14-0000
3071-751-23-0000	3071-751-50-0000	3071-761-14-0000	3071-762-05-0000	3071-771-15-0000
3071-751-24-0000	3071-751-51-0000	3071-761-15-0000	3071-762-06-0000	3071-771-17-0000
3071-751-25-0000	3071-751-52-0000	3071-761-16-0000	3071-762-07-0000	3071-771-18-0000
3071-751-26-0000	3071-751-53-0000	3071-761-17-0000	3071-762-08-0000	3071-771-19-0000
3071-751-27-0000	3071-751-54-0000	3071-761-18-0000	3071-762-09-0000	3071-771-20-0000

EXHIBIT "A"

PROPOSED ASSESSOR'S PARCELS
COMMUNITY FACILITIES DISTRICT NO. 2013-1
HESPERIA UNIFIED SCHOOL DISTRICT
COUNTY OF SAN BERNARDINO
STATE OF CALIFORNIA

Assessor's Parcel Numbers

3071-771-21-0000	3071-781-01-0000	3071-781-28-0000	3071-791-19-0000
3071-771-22-0000	3071-781-02-0000	3071-781-29-0000	3071-791-20-0000
3071-771-23-0000	3071-781-03-0000	3071-781-30-0000	3071-791-21-0000
3071-771-24-0000	3071-781-04-0000	3071-781-31-0000	3071-791-22-0000
3071-771-25-0000	3071-781-05-0000	3071-781-32-0000	3071-791-23-0000
3071-771-26-0000	3071-781-06-0000	3071-781-33-0000	3071-791-24-0000
3071-771-27-0000	3071-781-07-0000	3071-781-34-0000	3071-791-25-0000
3071-771-28-0000	3071-781-08-0000	3071-781-35-0000	3071-791-26-0000
3071-771-29-0000	3071-781-09-0000	3071-781-36-0000	3071-791-27-0000
3071-771-30-0000	3071-781-10-0000	3071-781-37-0000	3071-791-28-0000
3071-771-31-0000	3071-781-11-0000	3071-781-38-0000	3071-791-29-0000
3071-771-32-0000	3071-781-12-0000	3071-781-39-0000	3071-791-30-0000
3071-771-33-0000	3071-781-13-0000	3071-781-40-0000	3071-791-31-0000
3071-771-34-0000	3071-781-14-0000	3071-781-41-0000	3071-791-32-0000
3071-771-35-0000	3071-781-15-0000	3071-781-42-0000	3071-791-33-0000
3071-771-36-0000	3071-781-16-0000	3071-781-43-0000	3071-791-34-0000
3071-771-37-0000	3071-781-17-0000	3071-781-44-0000	3071-791-35-0000
3071-771-38-0000	3071-781-18-0000	3071-781-45-0000	3071-791-36-0000
3071-771-39-0000	3071-781-19-0000	3071-781-46-0000	3071-791-37-0000
3071-771-40-0000	3071-781-20-0000	3071-781-47-0000	3071-791-38-0000
3071-771-41-0000	3071-781-21-0000	3071-781-48-0000	3071-791-39-0000
3071-771-42-0000	3071-781-22-0000	3071-781-49-0000	3071-791-40-0000
3071-771-43-0000	3071-781-23-0000	3071-781-50-0000	3071-791-41-0000
3071-771-44-0000	3071-781-24-0000	3071-781-51-0000	3071-791-42-0000
3071-771-45-0000	3071-781-25-0000	3071-781-52-0000	3071-791-43-0000
3071-771-46-0000	3071-781-26-0000	3071-781-53-0000	3071-791-44-0000
3071-771-47-0000	3071-781-27-0000	3071-781-54-0000	3071-791-45-0000

PROPOSED ASSESSOR'S PARCELS
COMMUNITY FACILITIES DISTRICT NO. 2013-1
HESPERIA UNIFIED SCHOOL DISTRICT
COUNTY OF SAN BERNARDINO
STATE OF CALIFORNIA

Assessor's Parcel Numbers

3071-791-46-0000	3071-801-07-0000	3071-801-16-0000	3071-801-25-0000	3071-801-34-0000
3071-791-47-0000	3071-801-08-0000	3071-801-17-0000	3071-801-26-0000	3071-801-35-0000
3071-791-48-0000	3071-801-09-0000	3071-801-18-0000	3071-801-27-0000	3071-801-36-0000
3071-801-01-0000	3071-801-10-0000	3071-801-19-0000	3071-801-28-0000	3071-801-37-0000
3071-801-02-0000	3071-801-11-0000	3071-801-20-0000	3071-801-29-0000	3071-801-38-0000
3071-801-03-0000	3071-801-12-0000	3071-801-21-0000	3071-801-30-0000	3071-801-39-0000
3071-801-04-0000	3071-801-13-0000	3071-801-22-0000	3071-801-31-0000	3071-801-40-0000
3071-801-05-0000	3071-801-14-0000	3071-801-23-0000	3071-801-32-0000	3071-801-41-0000
3071-801-06-0000	3071-801-15-0000	3071-801-24-0000	3071-801-33-0000	3071-801-42-0000

EXHIBIT “B”

DESCRIPTION OF PUBLIC FACILITIES

The types of Facilities proposed to be planned for, designed, acquired, constructed, leased, expanded, improved, rehabilitated, funded, financed or refinanced by proposed Community Facilities District No. 2013-1 (“CFD”) of Hesperia Unified School District (“District”), under the Mello-Roos Community Facilities Act of 1982 (“Act”) are, as follows:

“Facilities” means any elementary, middle and high school facility with an estimated useful life of five (5) years or longer, including sites and site improvements (including landscaping, access roadways, drainage, sidewalks and gutters, utility lines, playground areas and equipment), classrooms, recreational facilities, on-site office space at a school, central support and administrative facilities, interim housing and transportation facilities needed by District in order to directly or indirectly serve the student population to be generated as a result of development of the property within CFD No. 2013-1. Notwithstanding the foregoing, the special tax revenues of CFD No. 2013-1 and the proceeds of Bonds of CFD No. 2013-1 that are supported by such special tax revenues, may be used or expended to redeem bonds of CFD No. 2004-1 issued prior to the formation of CFD No. 2013-1, to support debt service requirements on such bonds, and/or to convert and/or restructure, or assist in converting/restructuring such debt and costs thereof, which may, as a part thereof, include acquisition of or payment of costs of school facilities financed by CFD No. 2004-1 which have been substantially completed prior to the formation of CFD No. 2013-1.

“Facilities” may also include the attributable costs of engineering, design, planning, materials testing, coordination, construction staking and construction, together with the expenses related to issuance and sale of any “debt,” as defined in Section 53317(d) of the Act, including underwriters’ discount, appraisals, market studies, reserve fund, capitalized interest, bond counsel, special tax consultant, bond and official statement printing, administrative expenses of the School District, CFD No. 2013-1 and bond trustee(s) or fiscal agent(s) related to CFD No. 2013-1, and any such debt and all other incidental expenses.

The Facilities listed in this Exhibit are representative of the types of improvements to be furnished by CFD No. 2013-1. Addition, deletion or modification of descriptions of Facilities may be made consistent with the requirements of the District, CFD No. 2013-1, and the Act.

EXHIBIT "C"

**FIRST AMENDED RATE AND METHOD OF
APPORTIONMENT OF SPECIAL TAXES**

FIRST AMENDED RATE AND METHOD OF APPORTIONMENT OF SPECIAL TAXES OF COMMUNITY FACILITIES DISTRICT NO. 2013-1 OF THE HESPERIA UNIFIED SCHOOL DISTRICT

The following sets forth the First Amended Rate and Method of Apportionment for the levy and collection of Special Taxes in Community Facilities District No. 2013-1 ("CFD No. 2013-1") of Hesperia Unified School District ("School District"). The Special Taxes shall be levied on and collected in CFD No. 2013-1 each Fiscal Year in an amount determined through the application of the First Amended Rate and Method of Apportionment described below. All of the real property in CFD No. 2013-1 unless exempted by law or by the provisions hereof, shall be taxed for the purposes, to the extent, and in the manner herein provided.

**SECTION A
DEFINITIONS**

The terms hereinafter set forth have the following meanings:

"Act" means the Mello-Roos Communities Facilities Act of 1982 as amended, being Chapter 2.5, Division 2 of Title 5 of the Government Code of the State of California.

"Annual Special Tax" means the Special Tax levied by CFD No. 2013-1 in any given Fiscal Year on an Assessor's Parcel of Taxable Property as detailed in Section C. The Annual Special Tax is the maximum Special Tax which may be levied by CFD No. 2013-1 in any given Fiscal Year on an Assessor's Parcel of Taxable Property.

"Assessor's Parcel" means a lot or parcel of land designated on an Assessor's Parcel Map with an assigned Assessor's Parcel Number within the boundaries of CFD No. 2013-1.

"Assessor's Parcel Map" means an official map of the Assessor of the County designating parcels by Assessor's Parcel Number.

"Assessor's Parcel Number" or **"APN"** means that number assigned to an Assessor's Parcel by the County for purposes of identification.

"BMWD" means the Baldy Mesa Water District or any such successor agency.

"BMWD Obligations" means the unfunded obligations, if any, related to the joint community facilities agreement between the School District and BMWD, or any such successor agency, with regard to the developed property within CFD No. 2013-1.

"Board" means the Board of Trustees of Hesperia Unified School District as the legislative body of CFD No. 2013-1 or its authorized administrative delegate.

"Bonds" means any obligation to repay a sum of money, including obligations in the form of bonds, notes, certificates of participation, long-term leases, loans from government agencies, or loans from banks, other financial institutions, private businesses, or individuals, or long-term contracts, or any refunding thereof, which obligation may be incurred by CFD No. 2013-1.

"CFD No. 2013-1" means Community Facilities District No. 2013-1 of Hesperia Unified School District.

"Certification" means, prior to the issuance of Bonds by CFD No. 2013-1, the receipt by the Board of affirmation from i) BMWWD and ii) Empire Homes, Empire Homes Victorville 117 LP, Empire Homes Victorville 158 LP, or any such successor entity or assigned agency, stating the absence of remaining BMWWD Obligations with regard to the developed property within CFD No. 2013-1. The validity and satisfaction of the above items shall be reasonably determined by the Board. Subsequent to the issuance of Bonds by CFD No. 2013-1, the Board shall determine that Certification may no longer be awarded.

"Exempt Property" means all Assessor's Parcels designated as being exempt from Special Taxes in Section H.

"Fiscal Year" means the period commencing on July 1 of any year and ending the following June 30.

"Partial Prepayment Amount" means the amount required to prepay a portion of the Annual Special Tax obligation for an Assessor's Parcel, as described in Section F.

"Prepayment Administrative Fees" means the fees and expenses associated with the prepayment, including the costs of computation of the Prepayment Amount, costs of redeeming Bonds, and costs of recording any notices to evidence the prepayment and redemption of Bonds.

"Prepayment Amount" means the amount required to prepay the Annual Special Tax obligation in full for an Assessor's Parcel, as described in Section E.

"Present Value of Taxes" means the present value of any Annual Special Tax applicable to such Assessor's Parcel in the current Fiscal Year not yet received by the School District for CFD No. 2013-1, plus the expected Annual Special Tax applicable to such Assessor's Parcel in each remaining Fiscal Year until the termination date specified in Section G, using as the discount rate the Yield On The Bonds.

"Reserve Fund Credit" (if any) means, for each owner of an Assessor's Parcel wishing to prepay the Annual Special Tax obligation of such Assessor's Parcel, an amount equal to the lesser of (i) the reduction in the reserve requirement for the outstanding Bonds resulting from the redemption of Bonds with the applicable prepaid Special Taxes or (ii) the amount calculated by subtracting the new reserve requirement after the redemption of outstanding Bonds as a result of the prepayment from the balance in the reserve fund on the date of prepayment, but no reserve fund credit will be given if such amount is less than zero. Notwithstanding the above the Reserve Fund Credit applicable to an Assessor's Parcel requesting to prepay shall not exceed 10% of the amount of Bonds to be redeemed as a result of such prepayment. In the event that a surety bond or other credit instrument satisfies the reserve requirement, no Reserve Fund Credit shall be given.

"School District" means Hesperia Unified School District.

"Special Tax" means any of the special taxes authorized to be levied by CFD No. 2013-1 pursuant to the Act and this Rate and Method of Apportionment.

"Tax Class" means those tax classes for which each Assessor's Parcel within CFD No. 2013-1 has been assigned as designated in Exhibit A.

"Taxable Property" means all Assessor's Parcels which are not Exempt Property.

"Yield On The Bonds" means the yield for the last series of Bonds issued computed as prescribed by the applicable provisions of the Internal Revenue Code of 1986, as amended, and/or the applicable U.S. Treasury Regulations.

**SECTION B
CLASSIFICATION OF ASSESSOR'S PARCELS**

Each Fiscal Year, commencing with Fiscal Year 2013/2014, each Assessor's Parcel within CFD No. 2013-1 shall be classified as Taxable Property or Exempt Property. Furthermore, each Assessor's Parcel of Taxable Property shall be assigned to a Tax Class as designated in Exhibit A.

**SECTION C
ANNUAL SPECIAL TAX RATE**

Prior to Certification, the Annual Special Tax in a given Fiscal Year for each Assessor's Parcel of Taxable Property shall be the amount listed in Table C-1 below. Subsequent to Certification, the Annual Special Tax in a given Fiscal Year for each Assessor's Parcel of Taxable Property shall be the amount listed in Table C-2 below.

Table C-1

Fiscal Year	Tax Class 1	Tax Class 2	Tax Class 3	Tax Class 4	Tax Class 5	Tax Class 6	Tax Class 7
2013/2014	\$336.82	\$404.88	\$454.76	\$511.20	\$533.60	\$576.74	\$610.94
2014/2015	\$336.82	\$404.88	\$454.76	\$511.20	\$533.60	\$576.74	\$610.94
2015/2016	\$336.82	\$404.88	\$454.76	\$511.20	\$533.60	\$576.74	\$610.94
2016/2017	\$336.82	\$404.88	\$454.76	\$511.20	\$533.60	\$576.74	\$610.94
2017/2018	\$440.34	\$529.32	\$594.52	\$668.32	\$697.60	\$754.00	\$798.72
2018/2019	\$436.62	\$524.86	\$589.52	\$662.68	\$691.74	\$747.66	\$792.00
2019/2020	\$432.66	\$520.10	\$584.16	\$656.66	\$685.46	\$740.86	\$784.80
2020/2021	\$439.96	\$528.88	\$594.02	\$667.74	\$697.02	\$753.36	\$798.04
2021/2022	\$435.02	\$522.94	\$587.36	\$660.26	\$689.20	\$744.92	\$789.08
2022/2023	\$441.44	\$530.64	\$596.00	\$669.98	\$699.36	\$755.88	\$800.70
2023/2024	\$435.60	\$523.64	\$588.14	\$661.14	\$690.12	\$745.90	\$790.12
2024/2025	\$441.02	\$530.14	\$595.44	\$669.36	\$698.70	\$755.16	\$799.96
2025/2026	\$434.18	\$521.94	\$586.22	\$658.98	\$687.86	\$743.48	\$787.56
2026/2027	\$438.68	\$527.32	\$592.28	\$665.80	\$694.98	\$751.16	\$795.70
2027/2028	\$430.92	\$518.02	\$581.82	\$654.04	\$682.72	\$737.90	\$781.66
2028/2029	\$434.56	\$522.38	\$586.72	\$659.54	\$688.44	\$744.10	\$788.22
2029/2030	\$437.38	\$525.76	\$590.52	\$663.82	\$692.92	\$748.94	\$793.34
2030/2031	\$439.54	\$528.38	\$593.46	\$667.12	\$696.36	\$752.64	\$797.28
2031/2032	\$441.02	\$530.14	\$595.44	\$669.34	\$698.68	\$755.16	\$799.94
2032/2033	\$441.72	\$531.00	\$596.40	\$670.42	\$699.82	\$756.38	\$801.24
2033/2034	\$430.16	\$517.10	\$580.80	\$652.88	\$681.50	\$736.60	\$780.28
2034/2035	\$441.36	\$530.54	\$595.90	\$669.86	\$699.22	\$755.74	\$800.56
2035/2036	\$439.72	\$528.58	\$593.70	\$667.38	\$696.64	\$752.94	\$797.60
2036/2037	\$437.22	\$525.56	\$590.30	\$663.58	\$692.66	\$748.66	\$793.06
2037/2038	\$434.04	\$521.76	\$586.02	\$658.76	\$687.64	\$743.22	\$787.30
2038/2039	\$430.20	\$517.14	\$580.84	\$652.92	\$681.54	\$736.64	\$780.32
2039/2040	\$437.18	\$525.54	\$590.28	\$663.54	\$692.62	\$748.62	\$793.02
2040/2041	\$431.34	\$518.52	\$582.38	\$654.68	\$683.38	\$738.60	\$782.42
2041/2042	\$436.34	\$524.52	\$589.12	\$662.24	\$691.28	\$747.16	\$791.46
2042/2043	\$440.00	\$528.92	\$594.06	\$667.80	\$697.08	\$753.42	\$798.10

Table C-2

Fiscal Year	Tax Class 1	Tax Class 2	Tax Class 3	Tax Class 4	Tax Class 5	Tax Class 6	Tax Class 7
2013/2014	\$315.70	\$379.50	\$426.24	\$479.14	\$500.14	\$540.58	\$572.62
2014/2015	\$315.70	\$379.50	\$426.24	\$479.14	\$500.14	\$540.58	\$572.62
2015/2016	\$315.70	\$379.50	\$426.24	\$479.14	\$500.14	\$540.58	\$572.62
2016/2017	\$315.70	\$379.50	\$426.24	\$479.14	\$500.14	\$540.58	\$572.62
2017/2018	\$407.70	\$490.10	\$550.48	\$618.80	\$645.92	\$698.14	\$739.54
2018/2019	\$404.42	\$486.14	\$546.02	\$613.80	\$640.70	\$692.50	\$733.56
2019/2020	\$412.40	\$495.74	\$556.80	\$625.90	\$653.34	\$706.16	\$748.04
2020/2021	\$408.20	\$490.68	\$551.12	\$619.52	\$646.68	\$698.96	\$740.42
2021/2022	\$403.74	\$485.34	\$545.12	\$612.78	\$639.66	\$691.36	\$732.36
2022/2023	\$410.66	\$493.66	\$554.46	\$623.28	\$650.60	\$703.20	\$744.90
2023/2024	\$405.36	\$487.28	\$547.30	\$615.24	\$642.20	\$694.12	\$735.28
2024/2025	\$411.34	\$494.46	\$555.36	\$624.30	\$651.66	\$704.34	\$746.12
2025/2026	\$405.06	\$486.94	\$546.92	\$614.80	\$641.74	\$693.62	\$734.76
2026/2027	\$410.14	\$493.04	\$553.76	\$622.50	\$649.78	\$702.30	\$743.96
2027/2028	\$414.50	\$498.26	\$559.64	\$629.10	\$656.68	\$709.76	\$751.86
2028/2029	\$406.62	\$488.80	\$549.00	\$617.14	\$644.20	\$696.26	\$737.56
2029/2030	\$410.06	\$492.94	\$553.64	\$622.36	\$649.64	\$702.16	\$743.80
2030/2031	\$412.84	\$496.28	\$557.42	\$626.60	\$654.06	\$706.94	\$748.86
2031/2032	\$414.94	\$498.80	\$560.24	\$629.78	\$657.40	\$710.54	\$752.68
2032/2033	\$404.80	\$486.60	\$546.54	\$614.36	\$641.30	\$693.14	\$734.24
2033/2034	\$406.02	\$488.08	\$548.20	\$616.24	\$643.26	\$695.24	\$736.48
2034/2035	\$406.36	\$488.48	\$548.66	\$616.76	\$643.78	\$695.82	\$737.10
2035/2036	\$406.04	\$488.10	\$548.22	\$616.26	\$643.28	\$695.28	\$736.52
2036/2037	\$404.86	\$486.68	\$546.64	\$614.48	\$641.42	\$693.26	\$734.38
2037/2038	\$403.02	\$484.48	\$544.16	\$611.70	\$638.50	\$690.12	\$731.04
2038/2039	\$412.02	\$495.28	\$556.30	\$625.34	\$652.76	\$705.52	\$747.36
2039/2040	\$408.18	\$490.68	\$551.12	\$619.52	\$646.68	\$698.94	\$740.40
2040/2041	\$403.68	\$485.26	\$545.02	\$612.66	\$639.52	\$691.22	\$732.22
2041/2042	\$410.00	\$492.86	\$553.56	\$622.28	\$649.54	\$702.06	\$743.68
2042/2043	\$403.48	\$485.04	\$544.78	\$612.40	\$639.24	\$690.90	\$731.88

**SECTION D
METHOD OF APPORTIONMENT OF THE ANNUAL SPECIAL TAX**

Each Fiscal Year, commencing Fiscal Year 2013/2014, the Board shall levy an Annual Special Tax on each Assessor's Parcel of Taxable Property in an amount equal to the applicable amount provided in Section C.

**SECTION E
PREPAYMENT OF ANNUAL SPECIAL TAXES**

The Annual Special Tax obligation of an Assessor's Parcel of Taxable Property may be prepaid after the issuance of Bonds. An owner of an Assessor's Parcel intending to prepay the Annual Special Tax obligation shall provide CFD No. 2013-1 with written notice of intent to prepay. Within thirty (30) days of receipt of such written notice, the Board shall reasonably determine the Prepayment Amount for such Assessor's Parcel and shall notify such owner of such Prepayment Amount. In addition, any property owner prepaying his or her Annual Special Tax obligation must also pay all delinquent Special Taxes, interest and penalties owing on the Assessor's Parcel on which payment is being made, if any.

The Prepayment Amount shall be calculated according to the following formula:

$$P = PVT - RFC + PAF$$

The terms above have the following meanings:

P	=	Prepayment Amount
PVT	=	Present Value of Taxes
RFC	=	Reserve Fund Credit
PAF	=	Prepayment Administrative Fees

Notwithstanding the foregoing, no prepayment will be allowed unless the amount of Annual Special Taxes that may be levied on Taxable Property, net of Administrative Expenses, shall be at least 1.1 times the regularly scheduled annual interest and principal payments on all currently outstanding Bonds in each future Fiscal Year and such prepayment will not impair the security of all currently outstanding Bonds, as reasonably determined by the Board. Such determination shall include identifying all Assessor's Parcels that are expected to become Exempt Property.

With respect to any Assessor's Parcel that is prepaid, the Board shall indicate in the records of CFD No. 2013-1 that there has been a prepayment of the Annual Special Tax obligation and shall cause a suitable notice to be recorded in compliance with the Act to indicate the prepayment of the Annual Special Tax obligation and the release of the Annual Special Tax lien on such Assessor's Parcel, and the obligation of such Assessor's Parcel to pay such Annual Special Tax shall cease.

**SECTION F
PARTIAL PREPAYMENT OF ANNUAL SPECIAL TAXES**

The Annual Special Tax obligation of an Assessor's Parcel may be partially prepaid at the times and under the conditions set forth in this section, provided that there are no delinquent Special Taxes, penalties, or interest charges outstanding with respect to such Assessor's Parcel at the time the Annual Special Tax obligation would be prepaid.

1. Partial Prepayment Amount

The Partial Prepayment Amount shall be calculated according to the following formula:

$$PP = P_1 \times F$$

The terms above have the following meanings:

PP	=	the Partial Prepayment Amount
P ₁	=	the Prepayment Amount calculated according to Section E
F	=	the percent by which the owner of the Assessor's Parcel is partially prepaying the Annual Special Tax obligation

2. Partial Prepayment Procedures and Limitations

With respect to any Assessor's Parcel that is partially prepaid, the Board shall indicate in the records of CFD No. 2013-1 that there has been a partial prepayment of the Annual Special Tax obligation and shall cause a suitable notice to be recorded in compliance with the Act to indicate the partial prepayment of the Annual Special Tax obligation and the partial release of the Annual Special Tax lien on such Assessor's Parcel, and the obligation of such Assessor's Parcel to pay such prepaid portion of the Annual Special Tax shall cease. Additionally, the notice shall indicate that the Annual Special Tax for the Assessor's Parcels have been reduced by an amount equal to the percentage which was partially prepaid.

Notwithstanding the foregoing, no partial prepayment will be allowed unless the amount of Annual Special Taxes that may be levied on Taxable Property after such partial prepayment, net of Administrative Expenses, shall be at least 1.1 times the regularly scheduled annual interest and principal payments on all currently outstanding Bonds in each future Fiscal Year.

SECTION G TERMINATION OF SPECIAL TAX

Annual Special Taxes shall not be levied after Fiscal Year 2042/2043.

SECTION H EXEMPTIONS

The Board shall classify as Exempt Property (i) Assessor's Parcels owned by the State of California, Federal or other local governments, (ii) Assessor's Parcels which are used as places of worship and are exempt from *ad valorem* property taxes because they are owned by a religious organization, (iii) Assessor's Parcels used exclusively by a homeowners' association, and (iv) Assessor's Parcels with public or utility easements making impractical their utilization for other than the purposes set forth in the easement.

SECTION I CLAIMS

Any property owner claiming that the amount or application of the Special Tax is not correct may file a written notice of appeal with the Board not later than ninety (90) days after having paid the first installment of the Special Tax that is disputed. In order to be considered sufficient, any claim must: (i) specifically identify the property by address and Assessor's Parcel Number; (ii) state the amount in dispute and whether it is the whole amount or only a portion of the Special Tax; (iii) state all grounds on which the property owner is disputing the amount or application of the Special Tax, including a reasonably detailed explanation as to why the amount or application of such Special Tax is incorrect; (iv) include all documentation, if any, in support of the claim; and (v) be verified under penalty of perjury by the person who paid the Special Tax or his or her guardian, executor or administrator. A representative(s) of CFD No. 2013-1 ("Representative") shall promptly review the claim, and if necessary, meet with the property owner, consider written and oral evidence regarding the amount of the Special Tax, and rule on the claim. The decisions of the Representative(s) shall be final and binding. If the Representative's decision requires that the Special Tax for an Assessor's Parcel be modified or changed in favor of the property owner, a cash refund shall not be made (except for the last year of levy), but an adjustment shall be made to the Annual Special Tax on that Assessor's Parcel in the subsequent Fiscal Year(s) as the Representative's decisions shall indicate.

SECTION J
MANNER OF COLLECTION

The Annual Special Tax shall be collected in the same manner and at the same time as ordinary *ad valorem* property taxes, provided, however, that CFD No. 2013-1 may collect Annual Special Taxes at a different time or in a different manner if necessary to meet its financial obligations, including the ability to direct bill the properties in CFD No. 2013-1.

S:\Clients\Hesperia Unified SD\Finance\CFDs\CFD No. 2013-1\Formation\Rate and Method\RMA_ROF_FN.docx

EXHIBIT A

ASSIGNMENT OF ASSESSOR'S PARCELS TO TAX CLASSES

**HESPERIA UNIFIED SCHOOL DISTRICT
COMMUNITY FACILITIES DISTRICT NO. 2013-1
EXHIBIT A**

Assessor's Parcel Number*	Address	Tax Class
3071-751-03-0000	11930 MESA LINDA ST, VICTORVILLE CA 92392	1
3071-751-07-0000	11976 MESA LINDA ST, VICTORVILLE CA 92392	1
3071-751-10-0000	11993 AUTUMN WIND AVE, VICTORVILLE CA 92392	1
3071-751-18-0000	11903 AUTUMN WIND LN, VICTORVILLE CA 92392	1
3071-751-20-0000	11922 AUTUMN WIND AVE, VICTORVILLE CA 92392	1
3071-751-22-0000	11946 AUTUMN WIND LN, VICTORVILLE CA 92392	1
3071-751-26-0000	11984 AUTUMN WIND AVE, VICTORVILLE CA 92392	1
3071-751-28-0000	11993 CRANDALL CT, VICTORVILLE CA 92392	1
3071-751-40-0000	11984 CRANDALL CT, VICTORVILLE CA 92392	1
3071-751-44-0000	11977 GARRET LN, VICTORVILLE CA 92392	1
3071-751-51-0000	12412 SIERRA LN, VICTORVILLE CA 92392	1
3071-751-62-0000	11984 GARRET LN, VICTORVILLE CA 92392	1
3071-761-01-0000	11993 RUSSELL CT, VICTORVILLE CA 92392	1
3071-761-09-0000	11946 RUSSELL CT, VICTORVILLE CA 92392	1
3071-761-16-0000	11985 CLAYTON CT, VICTORVILLE CA 92392	1
3071-761-32-0000	11958 CLAYTON LN, VICTORVILLE CA 92392	1
3071-761-36-0000	11992 CLAYTON LN, VICTORVILLE CA 92392	1
3071-762-05-0000	11959 TAYLOR CT, VICTORVILLE CA 92392	1
3071-762-13-0000	11984 TAYLOR CT, VICTORVILLE CA 92392	1
3071-751-02-0000	11922 MESA LINDA ST, VICTORVILLE CA 92392	2
3071-751-05-0000	11958 MESA LINDA ST, VICTORVILLE CA 92392	2
3071-751-08-0000	11984 MESA LINDA ST, VICTORVILLE CA 92392	2
3071-751-12-0000	11977 AUTUMN WIND AVE, VICTORVILLE CA 92392	2
3071-751-14-0000	11959 AUTUMN WIND AVE, VICTORVILLE CA 92392	2
3071-751-16-0000	11931 AUTUMN WIND AVE, VICTORVILLE CA 92392	2
3071-751-24-0000	11968 AUTUMN WIND AVE, VICTORVILLE CA 92392	2
3071-751-27-0000	11992 AUTUMN WIND AVE, VICTORVILLE CA 92392	2
3071-751-30-0000	11977 CRANDALL CT, VICTORVILLE CA 92392	2
3071-751-32-0000	11959 CRANDALL CT, VICTORVILLE CA 92392	2
3071-751-34-0000	11933 CRANDALL CT, VICTORVILLE CA 92392	2
3071-751-36-0000	11946 CRANDALL CT, VICTORVILLE CA 92392	2
3071-751-38-0000	11968 CRANDALL CT, VICTORVILLE CA 92392	2
3071-751-42-0000	11993 GARRET LN, VICTORVILLE CA 92392	2
3071-751-45-0000	11969 GARRET LN, VICTORVILLE CA 92392	2
3071-751-47-0000	11947 GARRET LN, VICTORVILLE CA 92392	2
3071-751-50-0000	11903 GARRET LN, VICTORVILLE CA 92392	2
3071-751-53-0000	12436 SIERRA LN, VICTORVILLE CA 92392	2
3071-751-56-0000	11922 GARRET LN, VICTORVILLE CA 92392	2
3071-751-59-0000	11958 GARRET LN, VICTORVILLE CA 92392	2
3071-751-61-0000	11976 GARRET LN, VICTORVILLE CA 92392	2

**HESPERIA UNIFIED SCHOOL DISTRICT
COMMUNITY FACILITIES DISTRICT NO. 2013-1
EXHIBIT A**

Assessor's Parcel Number*	Address	Tax Class
3071-761-03-0000	11977 RUSSELL CT, VICTORVILLE CA 92392	2
3071-761-05-0000	11959 RUSSELL CT, VICTORVILLE CA 92392	2
3071-761-06-0000	11947 RUSSELL CT, VICTORVILLE CA 92392	2
3071-761-11-0000	11968 RUSSELL CT, VICTORVILLE CA 92392	2
3071-761-13-0000	11984 RUSSELL CT, VICTORVILLE CA 92392	2
3071-761-18-0000	11969 CLAYTON CT, VICTORVILLE CA 92392	2
3071-761-20-0000	11947 CLAYTON CT, VICTORVILLE CA 92392	2
3071-761-23-0000	11903 CLAYTON LN, VICTORVILLE CA 92392	2
3071-761-26-0000	12336 SIERRA RD, VICTORVILLE CA 92392	2
3071-761-28-0000	11906 CLAYTON LN, VICTORVILLE CA 92392	2
3071-761-30-0000	11930 CLAYTON LN, VICTORVILLE CA 92392	2
3071-761-34-0000	11976 CLAYTON LN, VICTORVILLE CA 92392	2
3071-762-01-0000	11993 TAYLOR CT, VICTORVILLE CA 92392	2
3071-762-03-0000	11977 TAYLOR CT, VICTORVILLE CA 92392	2
3071-762-10-0000	11958 TAYLOR CT, VICTORVILLE CA 92392	2
3071-762-12-0000	11976 TAYLOR CT, VICTORVILLE CA 92392	2
3071-762-16-0000	12224 SIERRA RD, VICTORVILLE CA 92392	2
3071-771-06-0000	12281 SIERRA RD, VICTORVILLE CA 92392	3
3071-771-10-0000	12331 SIERRA RD, VICTORVILLE CA 92392	3
3071-771-13-0000	12367 SIERRA RD, VICTORVILLE CA 92392	3
3071-771-15-0000	12360 BALI ST, VICTORVILLE CA 92392	3
3071-771-19-0000	12308 BALI ST, VICTORVILLE CA 92392	3
3071-771-26-0000	12212 BALI ST, VICTORVILLE CA 92392	3
3071-771-28-0000	12223 BALI ST, VICTORVILLE CA 92392	3
3071-771-47-0000	12393 SIERRA RD, VICTORVILLE CA 92392	3
3071-781-01-0000	12371 TAHITI ST, VICTORVILLE CA 92392	3
3071-781-06-0000	12321 TAHITI ST, VICTORVILLE CA 92392	3
3071-781-07-0000	12322 TAHITI ST, VICTORVILLE CA 92392	3
3071-781-08-0000	12334 TAHITI ST, VICTORVILLE CA 92392	3
3071-781-18-0000	12336 OAHU ST, VICTORVILLE CA 92392	3
3071-781-34-0000	12221 PAPEETE ST, VICTORVILLE CA 92392	3
3071-781-35-0000	12209 PAPEETE ST, VICTORVILLE CA 92392	3
3071-781-36-0000	12210 PAPEETE ST, VICTORVILLE CA 92392	3
3071-781-49-0000	12209 MARTINIQUE ST, VICTORVILLE CA 92392	3
3071-781-50-0000	12210 MARTINIQUE ST, VICTORVILLE CA 92392	3
3071-781-59-0000	11809 JAMAICA ST, VICTORVILLE CA 92392	3
3071-781-62-0000	11777 JAMAICA ST, VICTORVILLE CA 92392	3
3071-791-13-0000	12315 TRIPOLI ST, VICTORVILLE CA 92392	3
3071-791-14-0000	12322 TRIPOLI ST, VICTORVILLE CA 92392	3
3071-791-15-0000	12332 TRIPOLI ST, VICTORVILLE CA 92392	3

**HESPERIA UNIFIED SCHOOL DISTRICT
COMMUNITY FACILITIES DISTRICT NO. 2013-1
EXHIBIT A**

Assessor's Parcel Number*	Address	Tax Class
3071-791-21-0000	11725 GARRET LN, VICTORVILLE CA 92392	3
3071-791-27-0000	12246 SYCAMORE ST, VICTORVILLE CA 92392	3
3071-791-37-0000	12209 TORTUGA ST, VICTORVILLE CA 92392	3
3071-791-38-0000	12210 TORTUGA ST, VICTORVILLE CA 92392	3
3071-791-46-0000	11741 JAMAICA ST, VICTORVILLE CA 92392	3
3071-801-03-0000	12275 SYCAMORE ST, VICTORVILLE CA 92392	3
3071-801-13-0000	12264 BAYOU PL, VICTORVILLE CA 92392	3
3071-801-16-0000	12273 BAYOU PL, VICTORVILLE CA 92392	3
3071-801-29-0000	12279 MALAHINI PL, VICTORVILLE CA 92392	3
3071-801-37-0000	11641 BEACHCOMBER LN, VICTORVILLE CA 92392	3
3071-801-42-0000	11695 BEACHCOMBER LN, VICTORVILLE CA 92392	3
3071-751-01-0000	11906 MESA LINDA ST, VICTORVILLE CA 92392	4
3071-751-04-0000	11946 MESA LINDA ST, VICTORVILLE CA 92392	4
3071-751-06-0000	11968 MESA LINDA ST, VICTORVILLE CA 92392	4
3071-751-09-0000	11992 MESA LINDA ST, VICTORVILLE CA 92392	4
3071-751-11-0000	11985 AUTUMN WIND LN, VICTORVILLE CA 92392	4
3071-751-13-0000	11969 AUTUMN WIND LN, VICTORVILLE CA 92392	4
3071-751-15-0000	11947 AUTUMN WIND AVE, VICTORVILLE CA 92392	4
3071-751-17-0000	11923 AUTUMN WIND AVE, VICTORVILLE CA 92392	4
3071-751-19-0000	11906 AUTUMN WIND AVE, VICTORVILLE CA 92392	4
3071-751-21-0000	11930 AUTUMN WIND AVE, VICTORVILLE CA 92392	4
3071-751-23-0000	11958 AUTUMN WIND AVE, VICTORVILLE CA 92392	4
3071-751-25-0000	11976 AUTUMN WIND AVE, VICTORVILLE CA 92392	4
3071-751-29-0000	11985 CRANDALL CT, VICTORVILLE CA 92392	4
3071-751-31-0000	11969 CRANDALL CT, VICTORVILLE CA 92392	4
3071-751-33-0000	11947 CRANDALL CT, VICTORVILLE CA 92392	4
3071-751-35-0000	11930 CRANDALL CT, VICTORVILLE CA 92392	4
3071-751-37-0000	11958 CRANDALL CT, VICTORVILLE CA 92392	4
3071-751-39-0000	11976 CRANDALL CT, VICTORVILLE CA 92392	4
3071-751-41-0000	11992 CRANDALL CT, VICTORVILLE CA 92392	4
3071-751-43-0000	11985 GARRET LN, VICTORVILLE CA 92392	4
3071-751-46-0000	11959 GARRET LN, VICTORVILLE CA 92392	4
3071-751-48-0000	11931 GARRET LN, VICTORVILLE CA 92392	4
3071-751-49-0000	11923 GARRET LN, VICTORVILLE CA 92392	4
3071-751-52-0000	12424 SIERRA LN, VICTORVILLE CA 92392	4
3071-751-54-0000	12448 SIERRA LN, VICTORVILLE CA 92392	4
3071-751-55-0000	11906 GARRET LN, VICTORVILLE CA 92392	4
3071-751-57-0000	11930 GARRET LN, VICTORVILLE CA 92392	4
3071-751-58-0000	11946 GARRET LN, VICTORVILLE CA 92392	4
3071-751-60-0000	11968 GARRET LN, VICTORVILLE CA 92392	4

**HESPERIA UNIFIED SCHOOL DISTRICT
COMMUNITY FACILITIES DISTRICT NO. 2013-1
EXHIBIT A**

Assessor's Parcel Number*	Address	Tax Class
3071-751-63-0000	11992 GARRET LN, VICTORVILLE CA 92392	4
3071-761-02-0000	11985 RUSSELL CT, VICTORVILLE CA 92392	4
3071-761-04-0000	11969 RUSSELL CT, VICTORVILLE CA 92392	4
3071-761-07-0000	11933 RUSSELL CT, VICTORVILLE CA 92392	4
3071-761-08-0000	RUSSELL CT, VICTORVILLE CA 92392	4
3071-761-10-0000	11958 RUSSELL CT, VICTORVILLE CA 92392	4
3071-761-12-0000	11976 RUSSELL CT, VICTORVILLE CA 92392	4
3071-761-14-0000	11992 RUSSELL CT, VICTORVILLE CA 92392	4
3071-761-15-0000	11993 CLAYTON LN, VICTORVILLE CA 92392	4
3071-761-17-0000	11977 CLAYTON CT, VICTORVILLE CA 92392	4
3071-761-19-0000	11959 CLAYTON CT, VICTORVILLE CA 92392	4
3071-761-21-0000	11931 CLAYTON LN, VICTORVILLE CA 92392	4
3071-761-22-0000	11923 RUSSELL CT, VICTORVILLE CA 92392	4
3071-761-24-0000	12312 SIERRA RD, VICTORVILLE CA 92392	4
3071-761-25-0000	12324 SIERRA RD, VICTORVILLE CA 92392	4
3071-761-27-0000	12348 SIERRA RD, VICTORVILLE CA 92392	4
3071-761-29-0000	11922 CLAYTON LN, VICTORVILLE CA 92392	4
3071-761-31-0000	11946 CLAYTON LN, VICTORVILLE CA 92392	4
3071-761-33-0000	11968 CLAYTON LN, VICTORVILLE CA 92392	4
3071-761-35-0000	11984 CLAYTON LN, VICTORVILLE CA 92392	4
3071-762-02-0000	11985 TAYLOR CT, VICTORVILLE CA 92392	4
3071-762-04-0000	11969 TAYLOR CT, VICTORVILLE CA 92392	4
3071-762-06-0000	11947 TAYLOR CT, VICTORVILLE CA 92392	4
3071-762-07-0000	11933 TAYLOR CT, VICTORVILLE CA 92392	4
3071-762-08-0000	11930 TAYLOR CT, VICTORVILLE CA 92392	4
3071-762-09-0000	11946 TAYLOR CT, VICTORVILLE CA 92392	4
3071-762-11-0000	11968 TAYLOR CT, VICTORVILLE CA 92392	4
3071-762-15-0000	12212 SIERRA RD, VICTORVILLE CA 92392	4
3071-762-17-0000	12236 SIERRA RD, VICTORVILLE CA 92392	4
3071-762-18-0000	12248 SIERRA RD, VICTORVILLE CA 92392	4
3071-791-20-0000	11737 GARRET LN, VICTORVILLE CA 92392	4
3071-771-02-0000	12223 SIERRA RD, VICTORVILLE CA 92392	5
3071-771-04-0000	12257 SIERRA RD, VICTORVILLE CA 92392	5
3071-771-08-0000	12307 SIERRA RD, VICTORVILLE CA 92392	5
3071-771-11-0000	12343 SIERRA RD, VICTORVILLE CA 92392	5
3071-771-18-0000	12322 BALI ST, VICTORVILLE CA 92392	5
3071-771-20-0000	12296 BALI ST, VICTORVILLE CA 92392	5
3071-771-21-0000	12282 BALI ST, VICTORVILLE CA 92392	5
3071-771-23-0000	12258 BALI ST, VICTORVILLE CA 92392	5
3071-771-25-0000	12224 BALI ST, VICTORVILLE CA 92392	5

**HESPERIA UNIFIED SCHOOL DISTRICT
COMMUNITY FACILITIES DISTRICT NO. 2013-1
EXHIBIT A**

Assessor's Parcel Number*	Address	Tax Class
3071-771-27-0000	12211 BALI ST, VICTORVILLE CA 92392	5
3071-771-30-0000	12247 BALI ST, VICTORVILLE CA 92392	5
3071-771-32-0000	12269 BALI ST, VICTORVILLE CA 92392	5
3071-771-35-0000	11847 JAMAICA ST, VICTORVILLE CA 92392	5
3071-771-37-0000	12333 BALI ST, VICTORVILLE CA 92392	5
3071-771-38-0000	12345 BALI ST, VICTORVILLE CA 92392	5
3071-771-40-0000	12369 BALI ST, VICTORVILLE CA 92392	5
3071-771-41-0000	12381 BALI ST, VICTORVILLE CA 92392	5
3071-771-43-0000	11851 GARRET LN, VICTORVILLE CA 92392	5
3071-771-44-0000	11863 GARRET LN, VICTORVILLE CA 92392	5
3071-781-03-0000	12347 TAHITI ST, VICTORVILLE CA 92392	5
3071-781-05-0000	12329 TAHITI ST, VICTORVILLE CA 92392	5
3071-781-10-0000	12360 TAHITI ST, VICTORVILLE CA 92392	5
3071-781-12-0000	12373 OAHU ST, VICTORVILLE CA 92392	5
3071-781-14-0000	12347 OAHU ST, VICTORVILLE CA 92392	5
3071-781-15-0000	12335 OAHU ST, VICTORVILLE CA 92392	5
3071-781-17-0000	12322 OAHU ST, VICTORVILLE CA 92392	5
3071-781-19-0000	12348 OAHU ST, VICTORVILLE CA 92392	5
3071-781-20-0000	12358 OAHU ST, VICTORVILLE CA 92392	5
3071-781-22-0000	11827 GARRET LN, VICTORVILLE CA 92392	5
3071-781-24-0000	11807 GARRET LN, VICTORVILLE CA 92392	5
3071-781-26-0000	11785 GARRET LN, VICTORVILLE CA 92392	5
3071-781-30-0000	12271 PAPEETE ST, VICTORVILLE CA 92392	5
3071-781-31-0000	12257 PAPEETE ST, VICTORVILLE CA 92392	5
3071-781-33-0000	12233 PAPEETE ST, VICTORVILLE CA 92392	5
3071-781-37-0000	12222 PAPEETE ST, VICTORVILLE CA 92392	5
3071-781-39-0000	12246 PAPEETE ST, VICTORVILLE CA 92392	5
3071-781-40-0000	12258 PAPEETE ST, VICTORVILLE CA 92392	5
3071-781-42-0000	12282 PAPEETE ST, VICTORVILLE CA 92392	5
3071-781-43-0000	12283 MARTINIQUE ST, VICTORVILLE CA 92392	5
3071-781-45-0000	12257 MARTINIQUE ST, VICTORVILLE CA 92392	5
3071-781-46-0000	12245 MARTINIQUE ST, VICTORVILLE CA 92392	5
3071-781-48-0000	12221 MARTINIQUE ST, VICTORVILLE CA 92392	5
3071-781-51-0000	12222 MARTINIQUE ST, VICTORVILLE CA 92392	5
3071-781-52-0000	12234 MARTINIQUE ST, VICTORVILLE CA 92392	5
3071-781-54-0000	12258 MARTINIQUE ST, VICTORVILLE CA 92392	5
3071-781-55-0000	12270 MARTINIQUE ST, VICTORVILLE CA 92392	5
3071-781-57-0000	11825 JAMAICA ST, VICTORVILLE CA 92392	5
3071-781-58-0000	11815 JAMAICA ST, VICTORVILLE CA 92392	5
3071-781-60-0000	11801 JAMAICA ST, VICTORVILLE CA 92392	5

**HESPERIA UNIFIED SCHOOL DISTRICT
COMMUNITY FACILITIES DISTRICT NO. 2013-1
EXHIBIT A**

Assessor's Parcel Number*	Address	Tax Class
3071-781-61-0000	11789 JAMAICA ST, VICTORVILLE CA 92392	5
3071-781-63-0000	11765 JAMAICA ST, VICTORVILLE CA 92392	5
3071-791-03-0000	12324 SYCAMORE ST, VICTORVILLE CA 92392	5
3071-791-06-0000	12360 SYCAMORE ST, VICTORVILLE CA 92392	5
3071-791-09-0000	12361 TRIPOLI ST, VICTORVILLE CA 92392	5
3071-791-12-0000	12325 TRIPOLI ST, VICTORVILLE CA 92392	5
3071-791-16-0000	12342 TRIPOLI ST, VICTORVILLE CA 92392	5
3071-791-22-0000	11715 GARRET LN, VICTORVILLE CA 92392	5
3071-791-25-0000	12222 SYCAMORE ST, VICTORVILLE CA 92392	5
3071-791-29-0000	12270 SYCAMORE ST, VICTORVILLE CA 92392	5
3071-791-32-0000	12271 TORTUGA ST, VICTORVILLE CA 92392	5
3071-791-34-0000	12245 TORTUGA ST, VICTORVILLE CA 92392	5
3071-791-36-0000	12221 TORTUGA ST, VICTORVILLE CA 92392	5
3071-791-39-0000	12222 TORTUGA ST, VICTORVILLE CA 92392	5
3071-791-41-0000	12246 TORTUGA ST, VICTORVILLE CA 92392	5
3071-791-45-0000	11753 JAMAICA ST, VICTORVILLE CA 92392	5
3071-791-47-0000	11731 JAMAICA ST, VICTORVILLE CA 92392	5
3071-801-01-0000	12251 SYCAMORE ST, VICTORVILLE CA 92392	5
3071-801-04-0000	12283 SYCAMORE ST, VICTORVILLE CA 92392	5
3071-801-06-0000	12307 SYCAMORE ST, VICTORVILLE CA 92392	5
3071-801-08-0000	12314 BAYOU PL, VICTORVILLE CA 92392	5
3071-801-10-0000	12296 BAYOU PL, VICTORVILLE CA 92392	5
3071-801-12-0000	12272 BAYOU PL, VICTORVILLE CA 92392	5
3071-801-14-0000	12252 BAYOU PL, VICTORVILLE CA 92392	5
3071-801-17-0000	12287 BAYOU PL, VICTORVILLE CA 92392	5
3071-801-19-0000	12309 BAYOU PL, VICTORVILLE CA 92392	5
3071-801-21-0000	12312 MALAHINI PL, VICTORVILLE CA 92392	5
3071-801-23-0000	12298 MALAHINI PL, VICTORVILLE CA 92392	5
3071-801-25-0000	12274 MALAHINI PL, VICTORVILLE CA 92392	5
3071-801-27-0000	12254 MALAHINI PL, VICTORVILLE CA 92392	5
3071-801-30-0000	12285 MALAHINI PL, VICTORVILLE CA 92392	5
3071-801-32-0000	12305 MALAHINI PL, VICTORVILLE CA 92392	5
3071-801-35-0000	11625 BEACHCOMBER LN, VICTORVILLE CA 92392	5
3071-801-39-0000	11663 BEACHCOMBER LN, VICTORVILLE CA 92392	5
3071-801-41-0000	11683 BEACHCOMBER LN, VICTORVILLE CA 92392	5
3071-771-01-0000	12211 SIERRA RD, VICTORVILLE CA 92392	6
3071-771-03-0000	12235 SIERRA RD, VICTORVILLE CA 92392	6
3071-771-05-0000	12269 SIERRA RD, VICTORVILLE CA 92392	6
3071-771-07-0000	12295 SIERRA RD, VICTORVILLE CA 92392	6
3071-771-09-0000	12319 SIERRA RD, VICTORVILLE CA 92392	6

**HESPERIA UNIFIED SCHOOL DISTRICT
COMMUNITY FACILITIES DISTRICT NO. 2013-1
EXHIBIT A**

Assessor's Parcel Number*	Address	Tax Class
3071-771-12-0000	12355 SIERRA RD, VICTORVILLE CA 92392	6
3071-771-14-0000	12372 BALI ST, VICTORVILLE CA 92392	6
3071-771-17-0000	12334 BALI ST, VICTORVILLE CA 92392	6
3071-771-22-0000	12270 BALI ST, VICTORVILLE CA 92392	6
3071-771-24-0000	12236 BALI ST, VICTORVILLE CA 92392	6
3071-771-29-0000	12233 BALI ST, VICTORVILLE CA 92392	6
3071-771-31-0000	12257 BALI ST, VICTORVILLE CA 92392	6
3071-771-33-0000	12281 BALI ST, VICTORVILLE CA 92392	6
3071-771-34-0000	11835 JAMAICA ST, VICTORVILLE CA 92392	6
3071-771-36-0000	12321 BALI ST, VICTORVILLE CA 92392	6
3071-771-39-0000	12357 BALI ST, VICTORVILLE CA 92392	6
3071-771-42-0000	11839 GARRET LN, VICTORVILLE CA 92392	6
3071-771-45-0000	11875 GARRET LN, VICTORVILLE CA 92392	6
3071-771-46-0000	12381 SIERRA RD, VICTORVILLE CA 92392	6
3071-781-02-0000	12351 TAHITI ST, VICTORVILLE CA 92392	6
3071-781-04-0000	12337 TAHITI ST, VICTORVILLE CA 92392	6
3071-781-11-0000	12372 TAHITI ST, VICTORVILLE CA 92392	6
3071-781-16-0000	12321 OAHU ST, VICTORVILLE CA 92392	6
3071-781-23-0000	11817 GARRET LN, VICTORVILLE CA 92392	6
3071-781-25-0000	11797 GARRET LN, VICTORVILLE CA 92392	6
3071-781-28-0000	11761 GARRET LN, VICTORVILLE CA 92392	6
3071-781-29-0000	12283 PAPEETE ST, VICTORVILLE CA 92392	6
3071-781-38-0000	12234 PAPEETE ST, VICTORVILLE CA 92392	6
3071-781-41-0000	12270 PAPEETE ST, VICTORVILLE CA 92392	6
3071-781-44-0000	12271 MARTINIQUE ST, VICTORVILLE CA 92392	6
3071-781-47-0000	12233 MARTINIQUE ST, VICTORVILLE CA 92392	6
3071-781-56-0000	12282 MARTINIQUE ST, VICTORVILLE CA 92392	6
3071-791-04-0000	12336 SYCAMORE ST, VICTORVILLE CA 92392	6
3071-791-07-0000	12372 SYCAMORE ST, VICTORVILLE CA 92392	6
3071-791-10-0000	12349 TRIPOLI ST, VICTORVILLE CA 92392	6
3071-791-18-0000	12372 TRIPOLI ST, VICTORVILLE CA 92392	6
3071-791-23-0000	11703 GARRET LN, VICTORVILLE CA 92392	6
3071-791-26-0000	12234 SYCAMORE ST, VICTORVILLE CA 92392	6
3071-791-40-0000	12234 TORTUGA ST, VICTORVILLE CA 92392	6
3071-791-43-0000	12270 TORTUGA ST, VICTORVILLE CA 92392	6
3071-801-02-0000	12263 SYCAMORE ST, VICTORVILLE CA 92392	6
3071-801-05-0000	12291 SYCAMORE ST, VICTORVILLE CA 92392	6
3071-801-09-0000	12306 BAYOU PL, VICTORVILLE CA 92392	6
3071-801-18-0000	12295 BAYOU PL, VICTORVILLE CA 92392	6
3071-801-24-0000	12286 MALAHINI PL, VICTORVILLE CA 92392	6

**HESPERIA UNIFIED SCHOOL DISTRICT
COMMUNITY FACILITIES DISTRICT NO. 2013-1
EXHIBIT A**

Assessor's Parcel Number*	Address	Tax Class
3071-801-31-0000	12293 MALAHINI PL, VICTORVILLE CA 92392	6
3071-801-36-0000	11633 BEACHCOMBER LN, VICTORVILLE CA 92392	6
3071-781-09-0000	12348 TAHITI ST, VICTORVILLE CA 92392	7
3071-781-13-0000	12359 OAHU ST, VICTORVILLE CA 92392	7
3071-781-21-0000	12372 OAHU ST, VICTORVILLE CA 92392	7
3071-781-27-0000	11773 GARRET LN, VICTORVILLE CA 92392	7
3071-781-32-0000	12245 PAPEETE ST, VICTORVILLE CA 92392	7
3071-781-53-0000	12246 MARTINIQUE ST, VICTORVILLE CA 92392	7
3071-791-01-0000	12300 SYCAMORE ST, VICTORVILLE CA 92392	7
3071-791-02-0000	12312 SYCAMORE ST, VICTORVILLE CA 92392	7
3071-791-05-0000	12348 SYCAMORE ST, VICTORVILLE CA 92392	7
3071-791-08-0000	12371 TRIPOLI ST, VICTORVILLE CA 92392	7
3071-791-11-0000	12337 TRIPOLI ST, VICTORVILLE CA 92392	7
3071-791-17-0000	12356 TRIPOLI ST, VICTORVILLE CA 92392	7
3071-791-19-0000	11749 GARRET LN, VICTORVILLE CA 92392	7
3071-791-24-0000	12210 SYCAMORE ST, VICTORVILLE CA 92392	7
3071-791-28-0000	12258 SYCAMORE ST, VICTORVILLE CA 92392	7
3071-791-30-0000	12282 SYCAMORE ST, VICTORVILLE CA 92392	7
3071-791-31-0000	12283 TORTUGA ST, VICTORVILLE CA 92392	7
3071-791-33-0000	12257 TORTUGA ST, VICTORVILLE CA 92392	7
3071-791-35-0000	12233 TORTUGA ST, VICTORVILLE CA 92392	7
3071-791-42-0000	12258 TORTUGA ST, VICTORVILLE CA 92392	7
3071-791-44-0000	12282 TORTUGA ST, VICTORVILLE CA 92392	7
3071-791-48-0000	11721 JAMAICA ST, VICTORVILLE CA 92392	7
3071-801-07-0000	12315 SYCAMORE ST, VICTORVILLE CA 92392	7
3071-801-11-0000	12284 BAYOU PL, VICTORVILLE CA 92392	7
3071-801-15-0000	12265 BAYOU PL, VICTORVILLE CA 92392	7
3071-801-20-0000	12317 BAYOU PL, VICTORVILLE CA 92392	7
3071-801-22-0000	12304 MALAHINI PL, VICTORVILLE CA 92392	7
3071-801-26-0000	12262 MALAHINI PL, VICTORVILLE CA 92392	7
3071-801-28-0000	12267 MALAHINI PL, VICTORVILLE CA 92392	7
3071-801-33-0000	12317 MALAHINI PL, VICTORVILLE CA 92392	7
3071-801-34-0000	11611 BEACHCOMBER LN, VICTORVILLE CA 92392	7
3071-801-38-0000	11655 BEACHCOMBER LN, VICTORVILLE CA 92392	7
3071-801-40-0000	11671 BEACHCOMBER LN, VICTORVILLE CA 92392	7

*Assessor's Parcel Numbers per the County of San Bernardino Assessor's Office as of the 2012 roll year.

EXHIBIT "D"

HESPERIA UNIFIED SCHOOL DISTRICT

Community Facilities District No. 2013-1

Election Day: _____, 2013

Ballot Measure Statement

Shall Community Facilities District No. 2013-1 ("CFD No. 2013-1") of the Hesperia Unified School District ("School District") be authorized to finance the cost of public school facilities, as described in Resolution No. 2012/13-27 of the School District, by incurring bonded indebtedness in a maximum amount of \$2,750,000, and shall CFD No. 2013-1 be authorized to levy special taxes on an annual basis, as shall be applicable, on property within CFD No. 2013-1, as set forth in Resolution Nos. 2012/13-21, as amended by Resolution No. 2012/13-26 and Resolution No. 2012/13-27, to pay for public school facilities and to pay for bonded indebtedness authorized under this Proposition _____, and for each year, commencing with fiscal year 2013-2014, shall an appropriations limit, as defined by Article XIII B of the California Constitution, be established for CFD No. 2013-1 in an amount equal to \$2,750,000, as periodically adjusted pursuant to applicable State law?