



June 3, 2011

Beau D. Cooper, LEED GA
Entitlement Manager
United Engineering Group
3595 Inland Empire Boulevard, Suite 2200
Ontario, California 91764

Subject: Archaeological Records Search of the Lucerne Valley Desert View Ranch Property (APNs 0435-083-39 and 0435-132-01), Unincorporated San Bernardino County, California (BCR Consulting Project Number UEN1101)

Dear Beau:

Brunzell Cultural Resource Consulting (BCR Consulting) was retained by United Engineering Group to conduct an Archaeological Records Search of the Lucerne Valley Desert View Ranch Property (Assessor Parcel Numbers [APNs] 0435-083-39 and 0435-132-01; the subject property) located in Unincorporated San Bernardino County, California. The subject property is located within the east half of Section 15 and the southeast quarter of Section 10, Township 4 North, Range 2 West, San Bernardino Baseline and Meridian. It is depicted on the U.S. Geological Survey (USGS) *Fifteen Mile Valley* (1971) 7.5 Minute Topographic Quadrangle (see Attachment A). The records search has indicated that two linear alignments within the subject property have been assessed during previous cultural resources studies (see Attachment A), and no known resources have been previously recorded within its boundaries.

Archaeological Records Search

The archaeological records search was conducted by BCR Consulting Principal/Archaeologist David Brunzell at the San Bernardino Archaeological Information Center (SBAIC), located at the San Bernardino County Museum in Redlands, California. The records search included a review of all recorded historic and prehistoric archaeological sites, as well as recorded built environment resources located within one mile of the subject property. The research also reviewed known cultural resources reports completed in the vicinity. All reports and resources are plotted on Attachment A. In addition, BCR Consulting examined the California State Historic Property Data File, which includes the National Register of Historic Places, California Historical Landmarks, California Points of Historical Interest, and various local historic registers. The following are the results of the records search:

USGS	Archaeological Sites	Reports
<i>Fifteen Mile Valley, 7.5 Minute USGS Quadrangle</i>	P-36-12659 (Historic Refuse Scatter) P-36-12667 (Historic Refuse Scatter) P-36-12668 (Historic Refuse Scatter) P-36-12669 (Historic Refuse Scatter) P-36-12670 (Historic Refuse Scatter) P-36-14477 (Historic Refuse Scatter) P-36-60779 (Prehistoric Lithic Scatter) CA-SBR-7284 (Historic Building Foundation)	SB- 1060046*, 1060108, 1061715, 1062515*, 1063019,1065227, 1065556, 1065580

*Crossed the subject property.

Results and Recommendations

The results of the records search indicate that eight cultural resource studies have taken place resulting in the recording of eight cultural resources within one mile of the subject property. Of the previous studies, two assessed linear portions of the subject property, and no cultural resources have been previously recorded within its boundaries. Since previous studies within the records search radius have revealed the presence of historic and prehistoric cultural resources, the subject property is considered potentially sensitive for cultural resources and should be subject to a full cultural resources assessment. The assessment should include the following tasks:

- Summary of the Current Records Search;
- Intensive Cultural Resources Field Survey;
- Native American Consultation;
- Cultural Resources Assessment Report.

The assessment should be performed under the supervision of a cultural resource professional that meets the Secretary of the Interior's Professional Qualification Standards for Archaeology.

If human remains are encountered within the subject property boundaries, State Health and Safety Code Section 7050.5 states that no further disturbance shall occur until the County Coroner has made a determination of origin and disposition pursuant to Public Resources Code Section 5097.98. The County Coroner must be notified of the find immediately. If the remains are determined to be prehistoric, the Coroner will notify the Native American Heritage Commission (NAHC), which will determine and notify a Most Likely Descendant (MLD). With the permission of the landowner or his/her authorized representative, the MLD may inspect the site of the discovery. The MLD shall complete the inspection within 48 hours of notification by the NAHC.

Please contact me by phone at 909/525-7078 or e-mail at david.brunzell@yahoo.com with any questions or comments.

Sincerely,



David Brunzell, M.A./RPA
Principal Investigator/Archaeologist

Attachment A: Archaeological Records Search Map

**ATTACHMENT A:
ARCHAEOLOGICAL RECORDS SEARCH MAP**

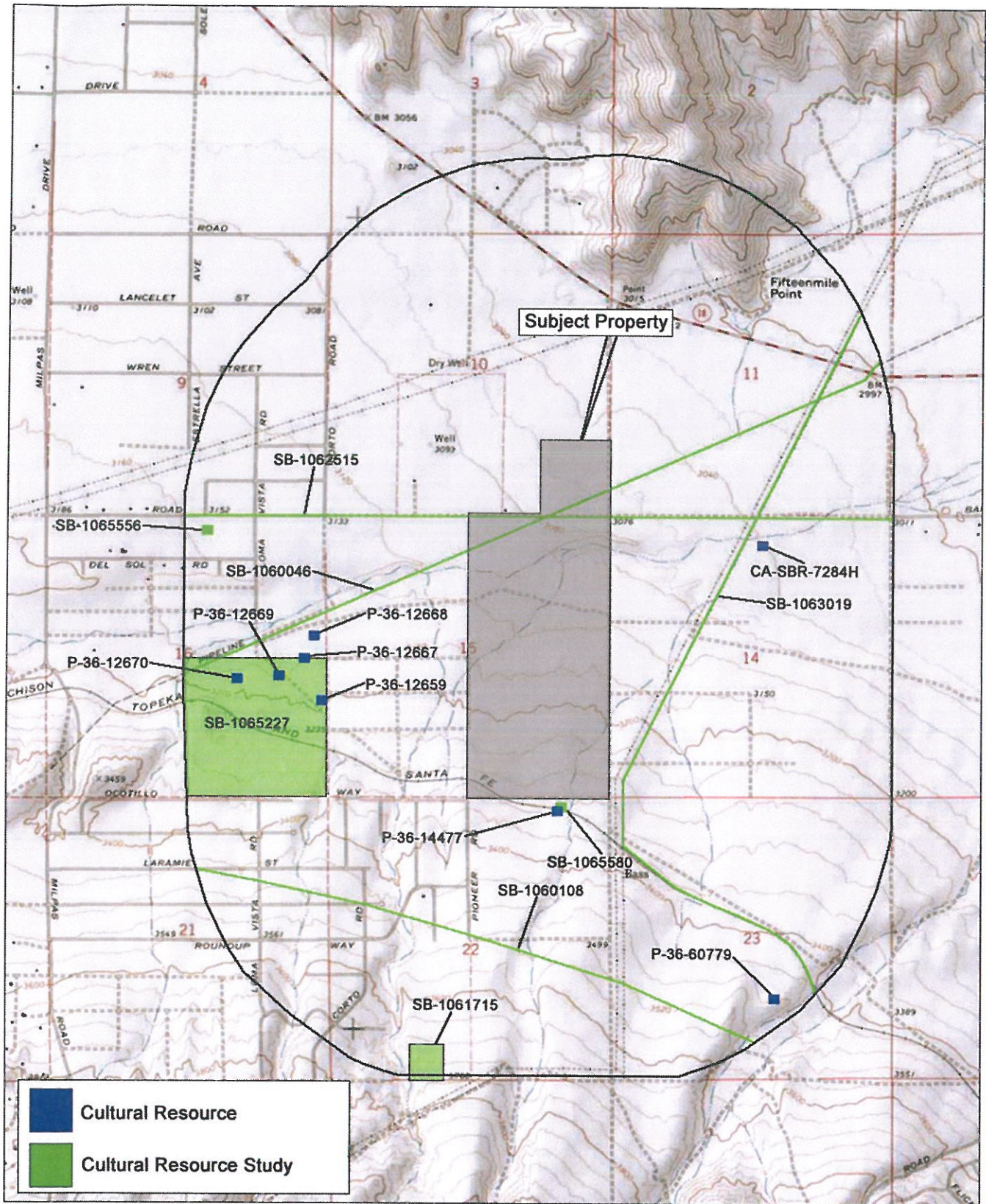

 BCRCONSULTING

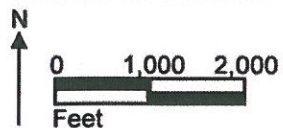

United Engineering Group
 Lucerne Valley Desert View Ranch
 Archaeological Records Search Map

SOURCE: Topol 2010 National Geographic; USGS Quad: Fifteen Mile Valley (1971), CA