

LOCAL AGENCY FORMATION COMMISSION FOR SAN BERNARDINO COUNTY

215 North "D" Street, Suite 204, San Bernardino, CA 92415-0490
(909) 388-0480 • Fax (909) 885-8170
E-mail: lafco@lafco.sbcounty.gov
www.sbclafco.org

PROPOSAL NO.: LAFCO 3199

HEARING DATE: FEBRUARY 17, 2016

RESOLUTION NO. 3215

A RESOLUTION OF THE LOCAL AGENCY FORMATION COMMISSION FOR SAN BERNARDINO COUNTY MAKING DETERMINATIONS ON LAFCO 3199 AND APPROVING THE SPHERE OF INFLUENCE EXPANSION FOR THE SAN BERNARDINO COUNTY FIRE PROTECTION DISTRICT (sphere amendment to include the entirety of the Twentynine Palms Water District boundary which encompasses approximately 56,919 acres (88.94 square miles)).

On motion of Commissioner Bagley, duly seconded by Commissioner Warren, and carried, the Local Agency Formation Commission adopts the following resolution:

WHEREAS, an application for the proposed sphere of influence amendment (expansion) in the County of San Bernardino was filed with the Executive Officer of this Local Agency Formation Commission (hereinafter referred to as "the Commission") in accordance with the Cortese-Knox-Hertzberg Local Government Reorganization Act of 2000 (Government Code Sections 56000 et seq.); and,

WHEREAS, at the times and in the form and manner provided by law, the Executive Officer has given notice of the public hearing by the Commission on this matter; and,

WHEREAS, the Executive Officer has reviewed available information and prepared a report including her recommendations thereon, the filings and report and related information having been presented to and considered by this Commission; and,

WHEREAS, the public hearing by this Commission was called for February 17, 2016 at the time and place specified in the notice of public hearing; and,

WHEREAS, at the hearing, this Commission heard and received all oral and written support and opposition; the Commission considered all objections and evidence which were made, presented, or filed; and all persons present were given an opportunity to hear and be heard in respect to any matter relating to the application, in evidence presented at the hearing; and,

WHEREAS, a statutory exemption has been issued pursuant to the provisions of the California Environmental Quality Act (CEQA) indicating that the sphere of influence amendment (expansion) is statutorily exempt from CEQA and such exemption was adopted by this Commission on February 17, 2016.

RESOLUTION NO. 3215

The Commission directed its Executive Officer to file a Notice of Exemption within five working days with the San Bernardino County Clerk of the Board of Supervisors; and,

WHEREAS, based on presently existing evidence, facts, and circumstances filed with the Local Agency Formation Commission and considered by this Commission, it is determined that the sphere of influence for the San Bernardino County Fire Protection District should be expanded to include the territory included within the boundaries of the Twentynine Palms Water District, as more specifically described on the attached Exhibits “A”, “A-1”, “B” and “B-1” to this resolution; and,

WHEREAS, the Commission determined on September 16, 2015 that a service review would not be required for this sphere of influence amendment as allowed by Government Code Section 56430;

WHEREAS, the following determinations are made in conformance with Government Code Section 56425 and local Commission policy:

1. The present and planned land uses in the area including agricultural and open space lands:

The land area proposed to be included in the sphere of influence of County Fire includes 56,919 acres of varied land uses. Approximately 45 percent of the expanded sphere area is within the City of Twentynine Palms. The City includes areas of rural living (45 percent), single family residential (34 percent), open space residential (3 percent) and public uses/floodway (3 percent).

The remainder of the sphere expansion area (outside the City) is also primarily residential in nature and includes: rural living (40 percent), single family residential (34 percent), open space residential (7 percent), multi-family residential (3 percent), commercial (4 percent), industrial (3 percent), and public uses and floodway (3 percent).

The chart, below, depicts the General Plan land use districts (in acres) within the TPWD (proposed sphere expansion area):

Land Use	Acres
City of Twentynine Palms Land Use Designations	
Rural Living	16,184
Single-Family Residential	11,962
Open Space Residential	2,463
Multi-Family Residential	1,056
Commercial	1,407
Institutional	1,056
Public and Floodway	1,056

RESOLUTION NO. 3215

County (unincorporated) Land Use Designations	
Resource Conservation (RC)	2,680
Rural Living (RL)	4,444
RL-5	14,571
RL-10	40
Floodway (FW)	
Service Commercial (CS)	
Institutional	
TOTAL SPHERE EXPANSION AREA	56,919

Source: Twentynine Palms Water District

Census data indicate that the Twentynine Palms Water District population was approximately 18,072 in 2010. The District's 2012 Service Review indicates that the service territory population is projected to reach 31,974 by 2040, an increase of 44 percent.¹ However, as stated in the Service Review, these projections may represent an unattainable growth trend based on the historic growth of the region. In addition to marginal growth over the last ten years, there are other circumstances in the region that tend to restrict growth (i.e. water quality issues, potential for development restrictions related to the use of septic systems, etc.). Based on these issues, actual growth is expected to be lower.

2. The present and probable need for public facilities and services in the area:

The current provision of fire protection and emergency medical response services provided by 29 Palms Fire was reduced from two fire stations to one staffed fire station on June 1, 2013 due to a lack of a sustainable revenue source. Without a change in governance, further reductions in service will be required to be implemented on July 1, 2016. Should these additional service cuts be implemented, the level of fire and emergency protection services provided by 29 Palms Fire may jeopardize public safety for residents and businesses within the Twentynine Palms Water District boundary.

Government Code Section 564215(e) (5) directs the Commission to evaluate the present and probable need for the delivery of structural fire protection within a disadvantaged unincorporated community. LAFCO 3199 addresses unincorporated area as well as an incorporated city area not required by the code section. However, the questions for assurance of service delivery to a disadvantaged community are real in this situation for both incorporated and unincorporated territory. The 2015 Disadvantaged Community Maps maintained by LAFCO identify that the bulk of the area within the Twentynine Palms Water District is disadvantaged and the Commission has an inherent responsibility to assure the continuation of this critical public health and safety service. The map below outlines the disadvantaged areas meeting the criteria of State law as earning less than \$48,305 per year (80% of Statewide median income):

¹ The projected District growth was calculated using a combination of growth rates identified in the Southern California Association of Governments (SCAG) Draft 2012 Regional Transportation Plan's Integrated Growth Forecast for the City of Twentynine Palms and County unincorporated data forecasts.

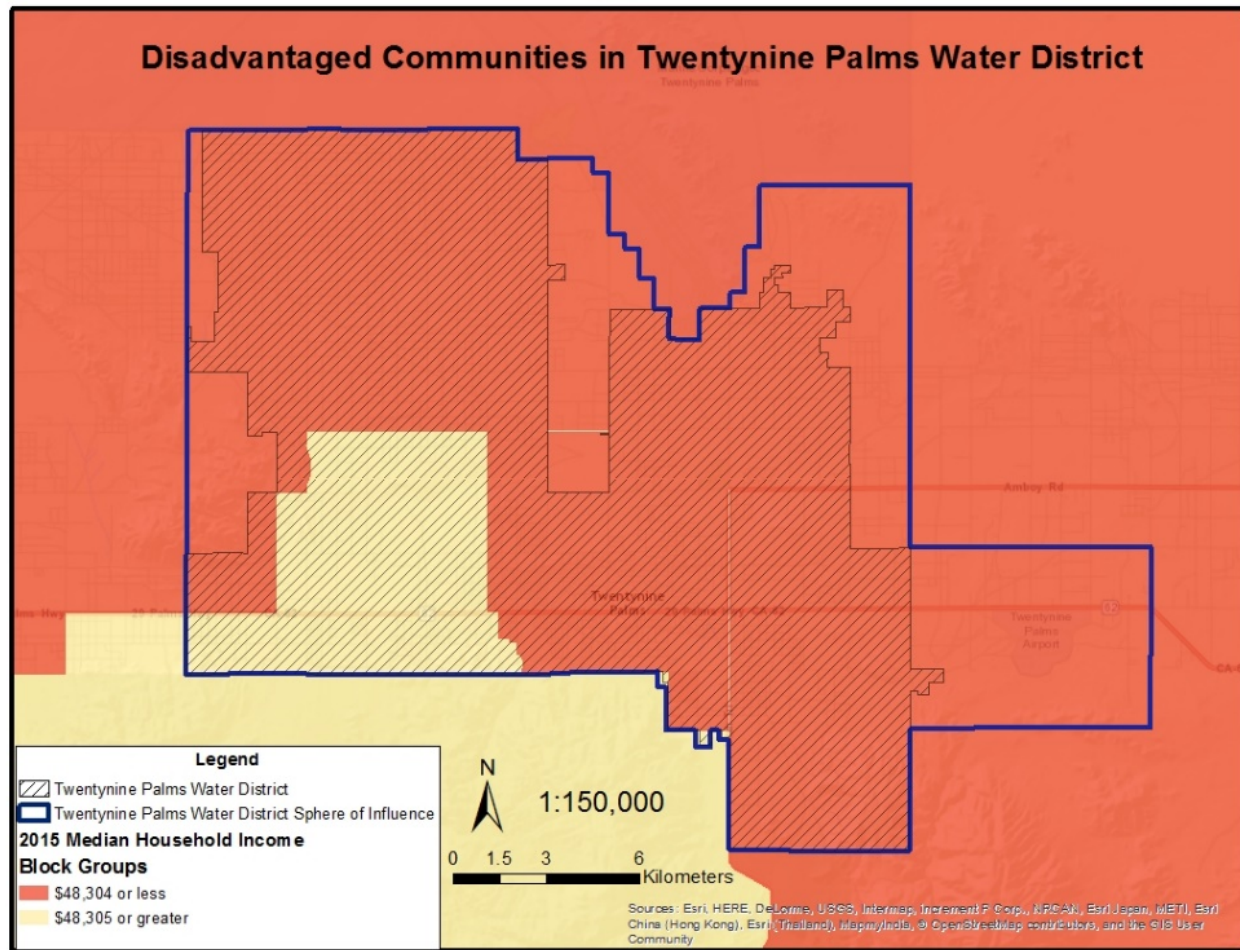

3. The present capacity of public facilities and adequacy of public services that the agency to be expanded provides or is authorized to provide:

County Fire operates 75 fire stations serving approximately 750,000 residents in approximately 16,535 acres of unincorporated territory plus seven incorporated cities including Adelanto, Fontana (through contract with subsidiary district), Grand Terrace, Hesperia (through contract with subsidiary district), Needles, Victorville, and Yucca Valley. County Fire provides a full range of emergency services, including ladder trucks, fire boats for water rescues, snow cats for winter operations, heavy equipment for flooding and earth moving, ambulance transportation in seven ambulance operating areas, paramedics and large incident command and control capability. County Fire is the largest provider of pre-hospital care in the County and the second largest ambulance provider.

The package of applications submitted by the Twentynine Palms Water District is intended to ensure adequate, long-term fire protection and emergency medical

RESOLUTION NO. 3215

response services for the residents of the District. The Twentynine Palms Water District can no longer afford to continue funding these services at appropriate levels.

4. The existence of any social or economic communities of interest as determined by the Commission to be relevant to the agency:

Social and economic communities of interest include: the City of Twentynine Palms, the Twentynine Palms Marine Corps Base, Joshua Tree National Park and the Morongo Unified School District. The Commission's 2012 Municipal Service Review clearly identified the community of Twentynine Palms as being the area of the sphere of influence assigned the Twentynine Palms Water District. The implementation of a fiscally sustainable agency to provide adequate levels of fire protection and emergency response, supports the economic and social community defined by the boundaries of the Twentynine Palms Water District over the long-term and is critical for the safety and well-being of the community's residents and travelers along Highway 62.

5. Additional Determinations

- Legal notice of the Commission's consideration of the proposal has been provided through publication of a 1/8th page advertisement in *The Sun* and *The Desert Trail*, newspapers of general circulation in the area. In addition, individual notices were provided to all affected and interested agencies, County departments and those individuals and agencies requesting special notice.
- The map and legal description for this sphere of influence amendment was prepared and certified by the County Surveyor's Office.

WHEREAS, pursuant to the provisions of Government Code Section 56425(i) the range of services provided by the San Bernardino County Fire Protection District shall be limited to the following:

San Bernardino County	Fire	Structural, watershed, prevention, inspection, suppression, weed abatement, hazardous materials services, rescue, first aid, ambulance transportation, emergency response, and disaster preparedness planning
------------------------------	------	---------------------------------------------------------------------------------------------------------------------------------------------------------------------------------------------------------------

As a function of LAFCO 3200, it is proposed that the Twentynine Palms Water District be divested of its fire authorities which would change its listing of active functions and services to the following:

Twentynine Palms	Water	Retail, agricultural, domestic, replenishment
	Sewer	Planning and engineering

The nature and location of the provision of the services by the San Bernardino County Fire Protection District to the Twentynine Palms community will be considered within the companion proposal, LAFCO 3200.

NOW, THEREFORE, BE IT RESOLVED by the Local Agency Formation Commission for San Bernardino County, State of California, that this Commission shall consider the territory described in Exhibits "A" and "A-1" as being within the sphere of influence of the San Bernardino County Fire Protection District, it being fully understood that the amendment of such sphere of influence is a policy declaration of this Commission based on existing facts and circumstances which, although not readily changed, may be subject to review and change in the event a future significant change of circumstances so warrants.

THIS ACTION APPROVED AND ADOPTED by the Local Agency Formation Commission for San Bernardino County by the following vote:

ABSENT: COMMISSIONERS: Lovingood, McCallon (Ms. Warren voting in his stead), Ramos

* * * * *

STATE OF CALIFORNIA)
) ss.
COUNTY OF SAN BERNARDINO)

I, KATHLEEN ROLLINGS-MCDONALD, Executive Officer of the Local Agency Formation Commission for San Bernardino County, California, do hereby certify this record to be a full, true, and correct copy of the action taken by said Commission by vote of the members present as the same appears in the Official Minutes of said Commission at its regular meeting of February 17, 2016.

DATED: February 17, 2016

appears in the Official Mi
2016



KA
Ex

KATHLEEN ROLLINGS-MCDONALD
Executive Officer

LAFCO 3199 – Sphere of Influence Amendment (Expansion) for the San Bernardino County Fire Protection District

LAFCO 3200 - Reorganization to include Annexation to the San Bernardino County Fire Protection District, its South Desert Service Zone, its Service Zone FP-5 and the Divestiture of the fire function from Twentynine Palms Water District

Area 1

Sphere of Influence Expansion for San Bernardino County Fire Protection District

Annexation to San Bernardino County Fire Protection District (SBCFPD) and its South Desert Service Zone

Those portions of the County of San Bernardino and the City of Twentynine Palms, State of California, lying within Section 6 Township 1 South, Range 10 East, San Bernardino Meridian, Sections 1 through 5, 9 through 15, Township 1 South, Range 9 East, San Bernardino Meridian, Sections 2 through 5, 8 through 11, 14 through 23 and 25 through 36, Township 1 North, Range 9 East, San Bernardino Meridian, Sections 1 through 6, 8 through 17 and 20 through 36, Township 1 North, Range 8 East, San Bernardino Meridian, Sections 31, 34 and 35, Township 2 North, Range 9 East, San Bernardino Meridian, Sections 19 through 36, Township 2 North, Range 8 East, San Bernardino Meridian described as follows:

Beginning at a point on the existing boundary of Twentynine Palms Water District per Lear Avenue annexation, LAFCO 2400, being the north quarter corner of said Section 20, Township 2 North, Range 8 East, San Bernardino Meridian, being in the unincorporated territory of the County of San Bernardino;

1. Thence easterly along said existing boundary of Twentynine Palms Water district and along the north lines of Sections 20, 21, 22, 23 and 24, a distance of 18480 feet, more or less to the north quarter corner of said Section 24, Township 2 North, Range 8 East, San Bernardino Meridian;
2. Thence southerly along said existing boundary and along the quarter section line of said Section 24 a distance of 2640 feet, more or less to the north line of the south half of said Section 24;
3. Thence continuing easterly along said existing boundary and along said north line a distance of 2640 feet, more or less to the east line of said Section 24;

4. Thence continuing southerly along said existing boundary and along the east lines of said sections 24, 25 and 36 a distance of 9240 feet, more or less to the north line of the west half of the north half of the south half of the northwest Quarter of Section 31, Township 2 North, Range 9 East, San Bernardino Meridian, also being a point on said existing boundary per annexation to 29-Palms Water District, LAFCO 2444;
5. Thence leaving said LAFCO 2400 and continuing easterly along said existing boundary and along said north line a distance of 1320 feet, more or less to the east line of said west half of the north half of the south half of the northwest Quarter of Section 31;
6. Thence continuing southerly along said existing boundary and along said east line a distance of 660 feet, more or less to the south line of said west half of the north half of the south half of the northwest Quarter of Section 31;
7. Thence continuing westerly along said existing boundary and along said south line a distance of 1320 feet, more or less to the east line of said Section 36, Township 2 North, Range 8 East, San Bernardino Meridian, also being a point on said annexation per LAFCO 2400;
8. Thence leaving said LAFCO 2444 and continuing southerly along said existing boundary of LAFCO 2400 and along the east line of said section 36 a distance of 3300 feet, more or less to the southeast corner of said Section 36, Township 2 North, Range 8 East, San Bernardino Meridian;
9. Thence continuing southerly along said existing boundary and along the east section lines of Sections 1, 12 and 13 a distance of 15840 feet, more or less to the southeast corner of said Section 13, Township 1 North, Range 8 East, San Bernardino Meridian, also being a point on said existing boundary per annexation 1964-1, LAFCO 39;
10. Thence leaving said annexation per LAFCO 2400 and continuing easterly along said existing boundary and along the north line of Section 19, Township 1 North, Range 9 East, San Bernardino Meridian, and annexation 1964-1, LAFCO 39, a distance of 3960 feet, more or less to the west line of the east half of the east half of said Section 19, being also a point on the boundary of Exhibit A, of approved petition for the incorporation of said Twentynine Palms County Water District, dated April 16, 1954;
11. Thence leaving said annexation 1964-1, LAFCO 39, and continuing easterly along said existing boundary, the north line of Section 19 and said Exhibit A, a distance of 1320 feet, more or less to southwest corner of Section 17, same township and range;
12. Thence continuing northerly along said existing boundary and along the west line of Section 17, same township and range, a distance of 4950 feet, more or less to the south line of the south half of the north half of the northeast quarter of the

- northeast quarter of the northeast quarter of Section 18, same township and range, being also a point on said existing boundary per said LAFCO 2400;
13. Thence leaving said Exhibit A and continuing westerly along said existing boundary of said LAFCO 2400 and along said south line of the south half of the north half of the northeast quarter of the northeast quarter of the northeast quarter of Section 18, same township and range, a distance of 660 feet, more or less to the west line of said south half;
 14. Thence continuing along said existing boundary and said west line of said south half, northerly a distance of 165 feet, more or less to the north line of said south half;
 15. Thence continuing easterly along said existing boundary and said north line of said south half, a distance of 660 feet, more or less to the west line of said Section 17, also being a point on said Exhibit A;
 16. Thence leaving said LAFCO 2400 and continuing northerly along said existing boundary, said west line and said Exhibit A, a distance of 5445 feet, more or less to the northwest corner of Section 8, Township 1 North, Range 9 East, San Bernardino Meridian, being also a point on annexation to said Twentynine Palms Water District per LAFCO 2717;
 17. Thence leaving said Exhibit A and continuing northerly along said existing boundary and along the west line of Section 5 and said annexation, a distance of 5280 feet, more or less to the northwest corner of said Section 5;
 18. Thence easterly along said existing boundary, the north line of said Section 5 and said annexation, a distance of 5280 feet more or less to the northeast corner of said Section 5, same township and range;
 19. Thence southerly along said existing boundary, the east line of said Section 5 and said annexation, a distance of 2640 feet, more or less to the west quarter corner of Section 4, being also a point on said annexation per LAFCO 2444;
 20. Thence leaving said annexation per LAFCO 2717 easterly along said existing boundary, the quarter section line of said Section 4 and said annexation of LAFCO 2444, a distance of 2640 feet, more or less to the center section corner of said Section 4, being also a point on said annexation per LAFCO 2400;
 21. Thence leaving said LAFCO 2444 and continuing northerly along said existing boundary, the quarter section line of said Section 4 and said annexation per LAFCO 2400, a distance of 2640 feet, more or less to the north quarter corner of said Section 4;
 22. Thence easterly along said existing boundary, the north lines of said Section 4 and Section 3 and said annexation, a distance of 5280, more or less to the south quarter corner of Section 34, Township 2 North, Range 9 East, San Bernardino Meridian;

23. Thence northerly along said existing boundary, the quarter section line of said Section 34 and said annexation, a distance of 1320 feet, more or less to the north line of the south half of the southeast quarter of said Section;
24. Thence easterly along said existing boundary, said north line and said annexation, a distance of 330 feet, more or less to the east line of the west half of the west half of the southeast quarter of said Section;
25. Thence northerly along said existing boundary, said east line and said annexation, a distance of 1320 feet, more or less to the north line of said southeast quarter;
26. Thence easterly along said existing boundary, said north line and said annexation, a distance of 660 feet, more or less to the west line of east half of the east half of the west half of the northeast quarter of said Section 34;
27. Thence northerly along said existing boundary, said west line and said annexation, a distance of 660 feet, more or less to the north line of the south half of the south half of said northeast quarter of said Section 34;
28. Thence easterly along said existing boundary, said north line and said annexation, a distance of 330 feet, more or less to the west line of the east half of said northeast quarter of said Section 34;
29. Thence northerly along said existing boundary, said west line and said annexation, a distance of 330 feet, more or less to the north line of the south half of the north half of the south half of said northeast quarter of said Section 34;
30. Thence easterly along said existing boundary, said north line and said annexation, a distance of 1320 feet, more or less to the east line of said Section 34;
31. Thence southerly along said existing boundary, said east line and said annexation, a distance of 660 feet, more or less to the south line of the north half of the south half of the south half of said northeast quarter of said Section 34;
32. Thence westerly along said existing boundary, said south line and said annexation, a distance of 660 feet, more or less to the east line of the west half of the east half of said Section 34;
33. Thence southerly along said existing boundary, said east line and said annexation, a distance of 330 feet, more or less to the north line of said southeast quarter of said Section 34;
34. Thence westerly along said existing boundary, said north line and said annexation, a distance of 660 feet, more or less to the east line of the west half of said southeast quarter of said Section;
35. Thence southerly along said existing boundary, said east line and said annexation, a distance of 660 feet, more or less to the north line of the south half of the north half of said southeast quarter of said Section 34;
36. Thence easterly along said existing boundary, said north line and said annexation, a distance of 330 feet, more or less to the east line of the west half of the west half of the east half of said southeast quarter of said Section;

37. Thence southerly along said existing boundary, said east line and said annexation, a distance of 660 feet, more or less to the north line of the south half of said southeast quarter of said Section 34;
38. Thence easterly along said existing boundary, said north line and said annexation, a distance of 990 feet, more or less to the east line of said Section 34;
39. Thence southerly along said existing boundary, said east line and said annexation, a distance of 1320 feet, more or less to the northwest corner of Section 2, Township 1 North, Range 9 East, San Bernardino Meridian;
40. Thence easterly along said existing boundary, said north line and said annexation, a distance of 3300 feet, more or less to west line of the east half of the southwest quarter of the southeast quarter of Section 35, Township 2 North, Range 9 East, San Bernardino Meridian, being also the southwest corner of Document No. 2009-0401685 O. R.;
41. Thence leaving said annexation per LAFCO 2400 and continuing northerly along said existing boundary, said west line and the west line of said Document, a distance of 495 feet, more or less to the northwest corner of said Document, also being the southwest corner of Document No. 1996-0224782 O. R.;
42. Thence continuing northerly along said existing boundary, said west line of the east half of the southwest quarter of the southeast quarter of said Section 35 and the west line of said Document No. 1996-0224782 O. R., a distance of 990 feet, more or less to the northwest corner of said Document;
43. Thence easterly along said existing boundary and the north line of said Document No. 1996-0224782 O. R., a distance of 1320 feet, more or less to the northeast corner of said Document;
44. Thence southerly along said existing boundary and the east line of said Document No. 1996-0224782 O. R., a distance of 990 feet, more or less to the southeast corner of said Document, being also the northeast corner of Document No. 1993-0309906 O. R.;
45. Thence continuing southerly along said existing boundary and the east line of said Document No. 1993-0309906 O. R., a distance of 495 feet, more or less to the southeast corner of said Document, being also a point on the north line of said Section 2, Township 1 North, Range 9 East, San Bernardino Meridian and said proposed annexation dated May 24, 1956;
46. Thence continuing easterly along said existing boundary of LAFCO 2400, said north line and said proposed annexation, a distance of 660 feet, more or less to the northeast corner of Section 2, Township 1 North, Range 9 East, San Bernardino Meridian;
47. Thence southerly along said existing boundary, the east line of said Section 2 and said proposed annexation dated May, 24, 1956, a distance of 1320 feet, more or

- less to the southeast corner of the northeast quarter of the northeast quarter of said Section 2;
48. Thence leaving said proposed annexation westerly along said existing boundary and the south line of said northeast quarter, a distance of 1320 feet, more or less to a point on the east line of the west half of the northeast quarter of said Section 2;
 49. Thence southerly along said existing boundary and said east line, a distance of 660 feet, more or less to a point on said east line of the west half of the northeast quarter of said Section 2, being also a point on said annexation per LAFCO 2400;
 50. Thence continuing southerly along said existing boundary, said east line and said annexation, a distance of 660 feet, more or less to the south line of the northeast quarter of said Section 2;
 51. Thence westerly along said existing boundary, said south line and said annexation, a distance of 1320 feet, more or less to the east line of the west half of said Section 2;
 52. Thence southerly along said existing boundary, said east line and said annexation, a distance of 1320 feet, more or less to the north line of the south half of the southeast quarter of said Section 2;
 53. Thence easterly along said existing boundary, said north line and said annexation, a distance of 660 feet, more or less to the east line of the west half of the west half of said southeast quarter of said Section 2;
 54. Thence southerly along said existing boundary, said east line and said annexation, a distance of 1320 feet, more or less to the south line of said Section 2, being also a point on said annexation per LAFCO 2717;
 55. Thence leaving said annexation per LAFCO 2400 easterly along said existing boundary, said south line of Section 2 and said annexation per LAFCO 2717, a distance of 1980 feet, more or less to the northeast corner of Section 11, same township and range;
 56. Thence southerly along said existing boundary, the east line of said Section 11 and said annexation per LAFCO 2717, a distance of 5280 feet, more or less to the southeast corner of said Section 11, also being a point on said annexation, LAFCO 2444 and the northeast corner of Section 14;
 57. Thence leaving said annexation per LAFCO 2717 and continuing southerly along said existing boundary, said east line of said Section 14 and said annexation per 2444, a distance of 1320 feet, more or less to the south line of the north half of the north half of said Section, being also a point on said annexation per LAFCO 2717;
 58. Thence leaving said annexation per LAFCO 2444 and continuing southerly along said existing boundary, said east line of said Section 14 and Section 23 and said annexation per LAFCO 2717, a distance of 6600 feet, more or less to the east

- quarter corner of Section 23, same township and range, being also a point on annexation 89-1 per LAFCO 2573;
59. Thence leaving said annexation per LAFCO 2717 and continuing southerly along said existing boundary, said east line of said Section 14 and Section 23 and said annexation per LAFCO 2573, a distance of 2640 feet, more or less to the northwest corner of Section 25, same township and range, also being a point on said annexation per LAFCO 2717;
 60. Thence leaving said annexation per LAFCO 2573 easterly along said existing boundary, along the north line of said Section 25 and said annexation per LAFCO 2717, a distance of 5280 feet, more or less to the northeast corner thereof;
 61. Thence southerly along said existing boundary, and the east line of said Section 25 and Section 36 and said annexation per LAFCO 2717, a distance of 10560 feet, more or less to the northwest corner of Section 6, Township 1 South, Range 10 East, San Bernardino Meridian, being also the corner of Township 1 North, Ranges 9 and 10 East, Township 1 South, per Document 92-261137 O. R., recorded June 22, 1992, and said annexation per LAFCO 2805;
 62. Thence leaving said annexation per LAFCO 2717 North 89° 44' East along said existing boundary and the south line of Section 31, Township 1 North, Range 10 East, and the boundary of said Document, and said annexation per LAFCO 2717 a distance of 2658.5 feet;
 63. Thence south along said existing LAFCO 2805 boundary and said Document boundary a distance of 1332.4 feet;
 64. Thence west along said existing LAFCO 2805 boundary and said Document boundary a distance of 1011.3 feet;
 65. Thence continuing south along said existing LAFCO 2805 boundary and said Document boundary a distance of 990 feet;
 66. Thence continuing west along said existing LAFCO 2805 boundary and said Document boundary a distance of 990 feet;
 67. Thence continuing north along said existing LAFCO 2805 boundary and said Document boundary a distance of 330 feet;
 68. Thence continuing west along said existing boundary LAFCO 2805 boundary and said Document boundary a distance of 660 feet, to the east line of said Section 1, Township 1 South, Range 9 East, San Bernardino Meridian, also being a point 1980 feet along said Section line, southerly of said Corner of Townships and Ranges, being also a point on said annexation per LAFCO 2717;
 69. Thence leaving said annexation per LAFCO 2805 and said Document boundary southerly along said existing boundary, said east lines of said Section 1 and Sections 12 and 13, same township and range and said annexation per LAFCO 2717, a distance of 13860 feet, more or less to the southeast corner of said Section 13, Township 1 South, Range 9 East, San Bernardino Meridian;

70. Thence easterly along said existing boundary and the south line of said Section 13 and Sections 14 and said annexation per LAFCO 2717, a distance of 10560 feet, more or less to the southwest corner of said Section 14, same township and range, being also a point on said annexation 89-1 per LAFCO 2573;
71. Thence leaving said annexation per LAFCO 2717 and continuing westerly along said existing boundary, the south line of Section 15 and said annexation 89-1 per LAFCO 2573, a distance of 5280 feet, more or less to the southwest corner of said Section 15;
72. Thence northerly along said existing boundary, the west line of said Section 15 and Section 10 and said annexation 89-1 per LAFCO 2573 a distance of 9900 feet, more or less to the southeast corner of the northeast quarter of the northeast quarter of Section 9, same township and range;
73. Thence leaving said annexation 89-1 westerly along said existing boundary and the south line of said northeast quarter, a distance of 660 feet, more or less to the west line of said northeast quarter;
74. Thence northerly along said existing boundary and said west line, a distance of 660 feet, more or less to the north line of said Section 9, also being a point on said Exhibit A, of approved petition for the incorporation of said Twentynine Palms County Water District, dated April 16, 1954;
75. Thence westerly along said existing boundary, said north line and the boundary of said Exhibit A, a distance of 990 feet, more or less to the northwest corner of the east half of the east half of the northwest quarter of the northeast quarter of said Section 9, being a point on annexation, LAFCO 1384;
76. Thence leaving said Exhibit A and continuing southerly along said existing boundary and the west line of said east half and said annexation, a distance of 1320 feet, more or less to the south line of the northwest quarter of the northeast quarter of said Section 9;
77. Thence continuing westerly along said existing boundary, said south line and said annexation, a distance of 990 feet, more or less to the west line of the northeast quarter of said Section 9;
78. Thence continuing northerly along said existing boundary, said west line and said annexation, a distance of 1320 feet, more or less to the north line of said Section 9, also being a point on said boundary of Exhibit A;
79. Thence leaving said annexation westerly along said existing boundary, said north line and said boundary of Exhibit A, of approved petition for the incorporation of said Twentynine Palms County Water District, dated April 16, 1954, a distance of 2640 feet, more or less to the southwest corner of Section 4, same township and range;
80. Thence northerly along said existing boundary, the west line of said section 4 and said boundary of Exhibit A, a distance of 4125.40 feet, more or less to the

southeast corner of Government Lot 1, per annexation 1961-1 of said Twentynine Palms Water District, Lying within Section 5, Township 1 South, Range 9 East, San Bernardino Meridian;

81. Thence leaving said Exhibit A South 89° 43' 56" West along said existing boundary, the south line of said Government Lot 1 and the south line of Lot 1, Tract No. 2710, a distance of 674 feet, to a point on a parallel line that is distant South 89° 05' West, 242 feet from the east line of said Lot 1, Tract No. 2710;
82. Thence North 0° 01' 20" East along said existing boundary, and said parallel line per said annexation 1961-1 and the boundary of said annexation, a distance of 1147 feet, to a point on the north line of said Lot 1 being South 89° 05' West, distant 242 feet from the northeast corner of said Lot 1, said point also being on the north line of said Section 5 and a point on said boundary of Exhibit A;
83. Thence leaving said annexation 1961-1 westerly along said existing boundary and said north lines Section 5 and Section 6 and along said boundary of Exhibit A, a distance of 9885.94 feet, more or less to the southeast corner of Section 36, Township 1 North, Range 8 East, San Bernardino Meridian;
84. Thence westerly along said existing boundary, the south lines of said Section 36 and Sections 35, 34 and 33, same township and range, and said boundary of Exhibit A, a distance of 21120 feet, more or less to the southwest corner of said Section 33, being also a point on said Water District boundary per annexation No. 1956-1;
85. Thence leaving said boundary of Exhibit A and continuing westerly along said existing boundary, the south lines of Sections 32 and 31, same township and range, and along said annexation a distance of 10560 feet, more or less to the southwest corner of said Section 31;
86. Thence northerly along said existing boundary, the west lines of said Section 31 and Section 30, same township and range, and along said annexation No. 1956 -1 and proposed annexation to said Water District dated September 19, 1962 distance of 10560 feet, more or less to the northwest corner of said Section 30;
87. Thence easterly along said existing boundary, the north line of said Section 30 and along said annexation No. 1956-1 and proposed annexation, a distance of 5280 feet, more or less to the southwest corner of Section 20, same township and range, being also a point on proposed annexation for said Water District dated April 19, 1963;
88. Thence leaving said annexation No. 1956-1 and continuing northerly along said existing boundary and the west line of said Section 20 and said proposed annexation a distance of 5280 to the northwest corner of said Section 20;
89. Thence easterly along said existing boundary, the north line of said Section 20 and along said proposed annexation, and annexation per LAFCO 2400, a distance of

- 2640 feet, more or less to the south quarter corner of Section 17, same township and range, being also a point on said annexation per LAFCO 2400;
90. Thence leaving said proposed annexation and continuing northerly along said existing boundary, the north-south quarter section line of said Section 17 and said annexation per LAFCO 2400, a distance of 5280 to the north quarter corner of said Section 17;
 91. Thence westerly along said existing boundary, the north line of said Section 17 and along said annexation, a distance of 1320 feet, more or less to the west line of the east half of the northwest quarter of said Section 17;
 92. Thence southerly along said existing boundary, said west line and along said annexation, a distance of 330 feet, more or less to the south line of the north half of the north half of the northwest quarter of said Section 17;
 93. Thence westerly along said existing boundary, said south line and along said annexation, LAFCO 2400, a distance of 1320 feet, to the west line of said Section 17;
 94. Thence northerly along said existing boundary, said west line of said Section 17 and Section 8 and along said annexation, a distance of 5610 feet, more or less to the southeast corner of Section 6, same township and range;
 95. Thence westerly along said existing boundary, along the south line of said Section 6, a distance of 5280 feet, more or less to the southwest corner of said Section;
 96. Thence northerly along said existing boundary, said west line of said Section 6 and along said annexation, a distance of 3960 feet, more or less to the north line of the south half of the northwest quarter of said Section 6;
 97. Thence easterly along said existing boundary, said north line and along said annexation, LAFCO 2400, a distance of 330 feet, more or less to the east line of the west half of the west half of the northwest quarter of said Section 6;
 98. Thence southerly along said existing boundary, said east line and along said annexation, a distance of 1320 feet, more or less to the south line of the northwest quarter of said Section 6;
 99. Thence easterly along said existing boundary, said south line and along said annexation, LAFCO 2400, a distance of 1980 feet, more or less to the west line of the east half of the east half of the northwest quarter of said Section 6;
 100. Thence northerly along said existing boundary, said west line and along said annexation, a distance of 2640 feet, more or less to the north line of said Section 6;
 101. Thence easterly along said existing boundary, said north line and along said annexation, LAFCO 2400, a distance of 330 feet, more or less to the south quarter corner of Section 31, Township 2 North, Range 8 East, San Bernardino Meridian;

102. Thence northerly along said existing boundary, the quarter section line and along said annexation, a distance of 5280 feet, more or less to the south line of said Section 30;
103. Thence westerly along said existing boundary, said south line and along said annexation, LAFCO 2400, a distance of 1320 feet, more or less to the west line of the east half of the west half of Section 30, Township 2 North, Range 8 East, San Bernardino Meridian;
104. Thence northerly along said existing boundary, said west line of the east half of the west half of said Section 30 and Section 19 and along said annexation, a distance of 5940 feet, more or less to the north line of the south half of the south half of said Section 19, also being a point on said annexation per LAFCO 2444;
105. Thence leaving said annexation, LAFCO 2400 and continuing northerly along said existing boundary, said west line of the east half of the west half of said Section 19 and along said annexation, LAFCO 2444, a distance of 4620 feet, more or less to the north line of said Section 19, same township and range;
106. Thence easterly along said existing boundary, said north lines of said Section 19 and Section 20 and along said annexation, a distance of 6600 feet, more or less to the **Point of Beginning**.

Containing 56775.09 acres, more or less.

This legal description was prepared by me or under my direction.

2/02/2016

James I. Stone

Date

Deputy County Surveyor

PLS 9075, Expiration: March 31, 2016



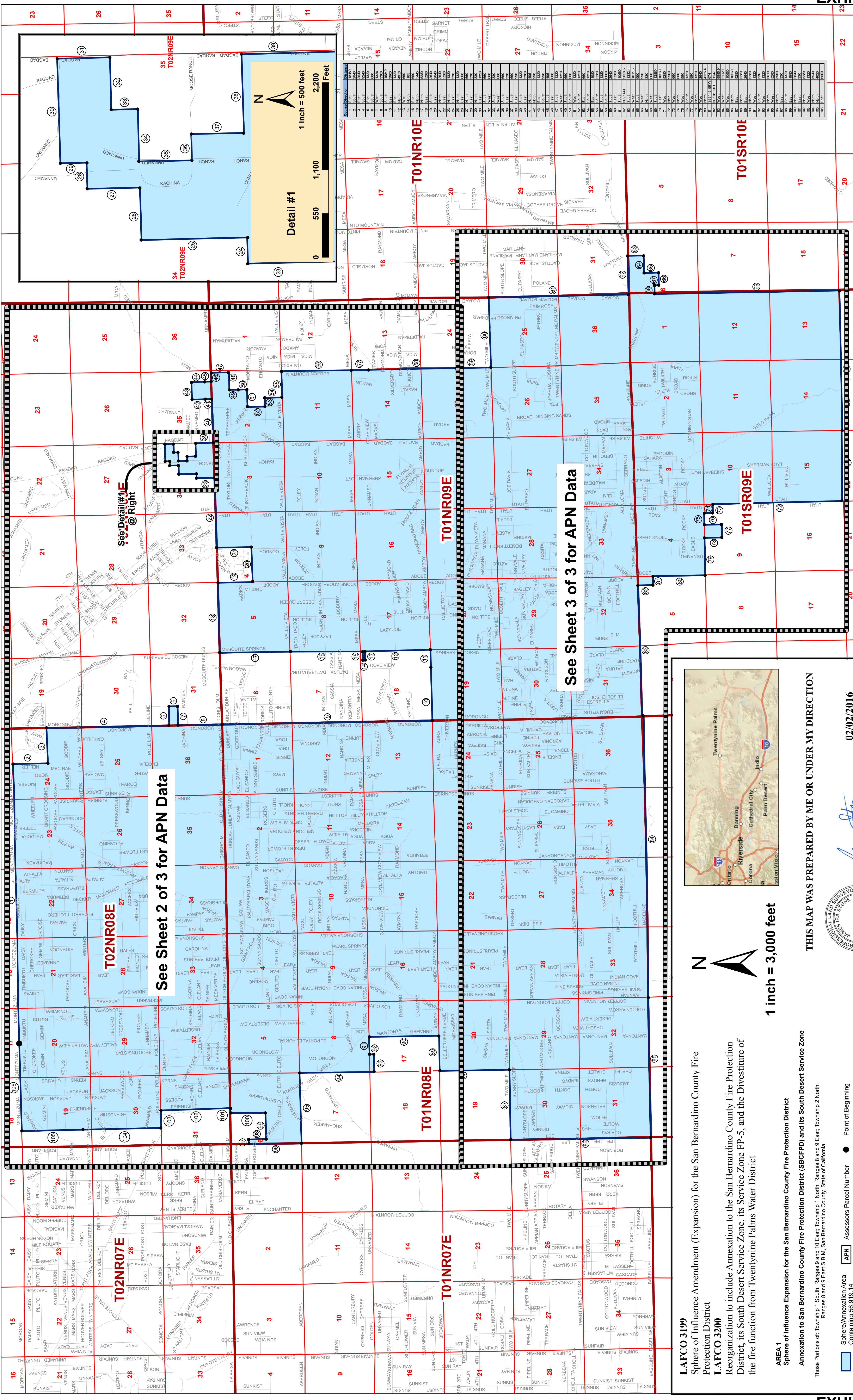

FOR QUESTIONS REGARDING THIS MAP OR TO OBTAIN A COPY OF THIS MAP IN ELECTRONIC FORM, PLEASE CONTACT
LAFCO FOR SAN BERNARDINO COUNTY

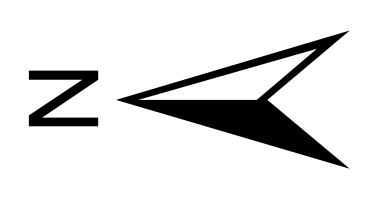
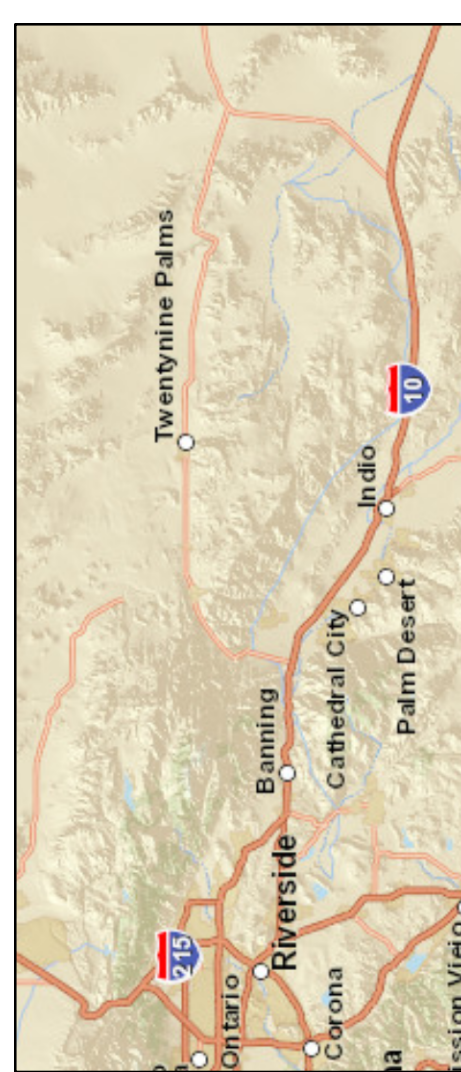

1 inch = 3,000 feet

LAFCO 3199
Sphere of Influence Amendment (Expansion) for the San Bernardino County Fire Protection District
LAFCO 3200
Reorganization to include Annexation to the San Bernardino County Fire Protection District, its South Desert Service Zone, its Service Zone FP-5, and the Divestiture of the fire function from Twentynine Palms Water District

AREA 1
Sphere of Influence Expansion for the San Bernardino County Fire Protection District
Annexation to San Bernardino County Fire Protection District (SBCFPD) and its South Desert Service Zone

Those Portions of: Township 1 South, Ranges 8 and 10 East; Township 1 North, Ranges 8 and 9 East; Township 2 North, Ranges 8 and 9 East S.B.M., San Bernardino County, State of California.

Sphere/Annexation Area Containing 56,913.14 Acres, More or Less

Assessors Parcel Number

Point of Beginning

Course Endpoint

Course Number

Section Lines

Parcels

0

3,000

6,000

12,000

18,000

24,000

Feet

James I. Stone

Deputy County Surveyor

PLS 9075

02/02/2016

Date

James I. Stone

Deputy County Surveyor

PLS 9075

Exp. 3/31/2016

Job Number 00220LF0 - Revised February 2, 2016

EXHIBIT A-1

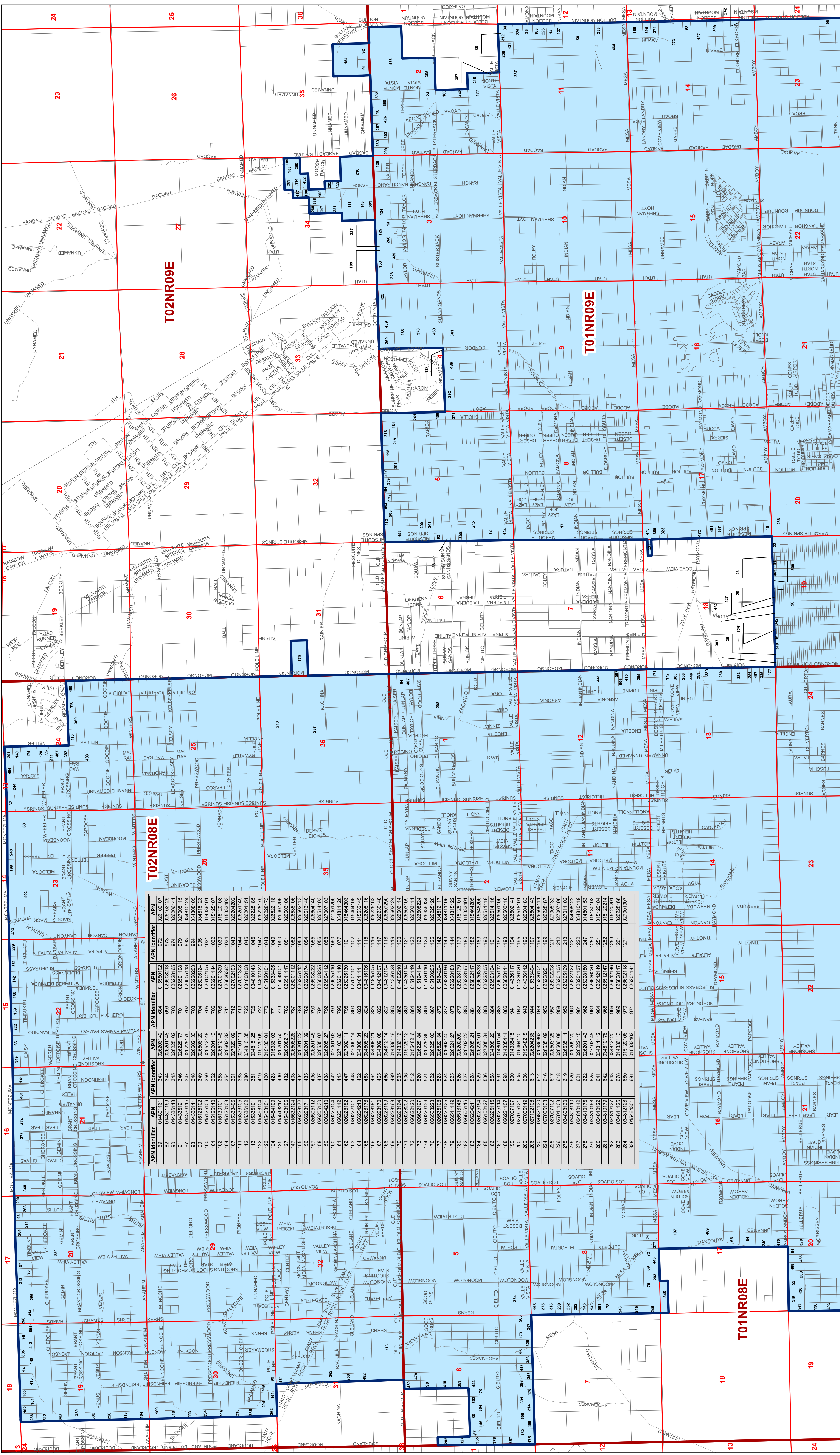

LAFCO 3199
Sphere of Influence Amendment (Expansion) for the San Bernardino
County Fire Protection District

LAFCO 3200
Reorganization to include Annexation to the San Bernardino County
Fire Protection District, its South Desert Service Zone, its Service Zone
FP-5 and the Divestiture of the fire function from Twentynine Palms
Water District

AREA 1
Sphere of Influence Expansion for the San Bernardino County Fire Protection District
Annexation to San Bernardino County Fire Protection District (SBCFPD) and its South Desert Service Zone
Those Portions of: Township 1 South, Ranges 9 and 10 East; Township 1 North, Ranges 8 and 9 East; Township 2 North,
Ranges 6 and 9 East S.B.M., San Bernardino County, State of California.

Legend:
■ Sphere/Annexation Area
● Assessors Parcel Number
● Point of Beginning
● Course Endpoint
● Course Number
□ Parcels
□ Section Lines
□ Acres, More or Less

0 1,700 3,400 6,800 10,200 13,600 Feet

EXHIBIT A-1
THIS MAP WAS PREPARED BY ME OR UNDER MY DIRECTION
02/02/2016
James I. Stone
Deputy County Surveyor
PLS 9075
Date
Exp. 3/31/2016
Job Number 002201.F0 - Revised February 2, 2016
SHEET 2 OF 3

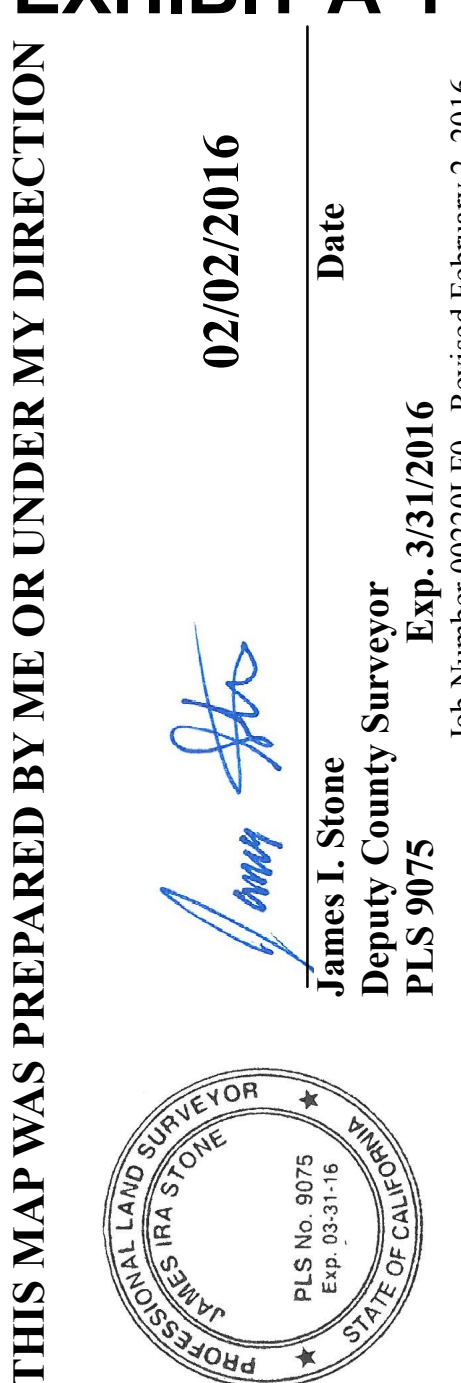

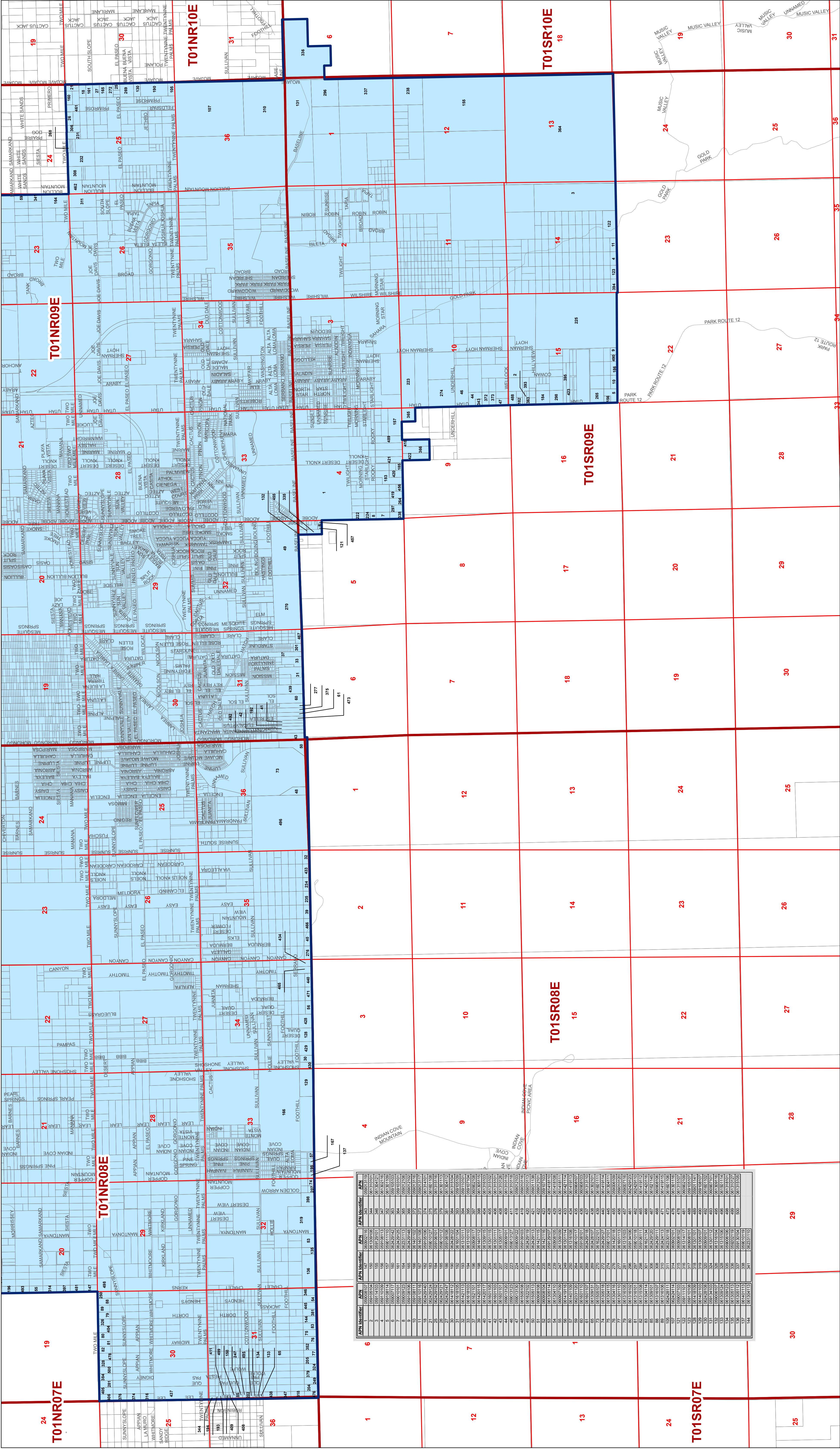

LAFCO 3199
Sphere of Influence Amendment (Expansion) for the San Bernardino County Fire Protection District

LAFCO 3200
Reorganization to include Annexation to the San Bernardino County Fire Protection District, its South Desert Service Zone, its Service Zone FP-5 and the Divestiture of the fire function from Twentynine Palms Water District

AREA 1
Sphere of Influence Expansion for the San Bernardino County Fire Protection District

Annexation to San Bernardino County Fire Protection District (SBCFPD) and its South Desert Service Zone
Those Portions of: Township 1 South, Ranges 9 and 10 East; Township 1 North, Ranges 8 and 9 East; Township 2 North, Ranges 6 and 9 East S.B.M. San Bernardino County, State of California.

☐ Sphere/Annexation Area Containing 55,919.14 Acres, More or Less

☐ Assessor's Parcel Number

☐ Section Lines

☐ Parcels

☐ Point of Beginning

☐ Course Endpoint

☐ Course Number

0 2,000 4,000 8,000 12,000 16,000 Feet

THIS MAP WAS PREPARED BY ME OR UNDER MY DIRECTION

James I. Stone
Deputy County Surveyor
PLS 9075

02/02/2016

Date

Exp. 3/31/2016
Job Number 002201.F0 - Revised February 2, 2016

SHEET 3 OF 3

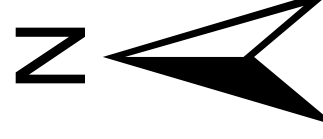

1 inch = 2,000 feet

EXHIBIT A-1

LAFCO 3199 – Sphere of Influence Amendment (Expansion) for the San Bernardino County Fire Protection District**LAFCO 3200 - Reorganization to include Annexation to the San Bernardino County Fire Protection District, its South Desert Service Zone, its Service Zone FP-5 and the Divestiture of the fire function from Twentynine Palms Water District****Area 2****Annexation to San Bernardino County Fire Protection District Service Zone FP-5**

Those portions of the County of San Bernardino and the City of Twentynine Palms, State of California, lying within Section 6 Township 1 South, Range 10 East, San Bernardino Meridian, Sections 1 through 5, 9 through 15, Township 1 South, Range 9 East, San Bernardino Meridian, Sections 2 through 5, 8 through 11, 14 through 23 and 25 through 36, Township 1 North, Range 9 East, San Bernardino Meridian, Sections 1 through 6, 8 through 17 and 20 through 36, Township 1 North, Range 8 East, San Bernardino Meridian, Sections 31, 34 and 35, Township 2 North, Range 9 East, San Bernardino Meridian, Sections 19 through 36, Township 2 North, Range 8 East, San Bernardino Meridian described as follows:

Beginning at a point on the existing boundary of Twentynine Palms Water District per Lear Avenue annexation, LAFCO 2400, being the north quarter corner of said Section 20, Township 2 North, Range 8 East, San Bernardino Meridian, being in the unincorporated territory of the County of San Bernardino;

1. Thence easterly along said existing boundary of Twentynine Palms Water district and along the north lines of Sections 20, 21, 22, 23 and 24, a distance of 18480 feet, more or less to the north quarter corner of said Section 24, Township 2 North, Range 8 East, San Bernardino Meridian (S.B.M.);
2. Thence southerly along said existing boundary and along the quarter section line of said Section 24 a distance of 2640 feet, more or less to the north line of the south half of said Section 24;
3. Thence continuing easterly along said existing boundary and along said north line a distance of 2640 feet, more or less to the east line of said Section 24;
4. Thence leaving said existing boundary and continuing easterly along the north line of the south half of Section 19, Township 2 North, Range 9 East, S.B.M. a distance of 3960 feet, more or less to the west line of the east half of the southeast quarter of said Section 19;

5. Thence southerly along said west line a distance of 1320 feet, more or less to the north line of the southeast quarter of the southeast quarter of said Section 19;
6. Thence easterly along said north line a distance of 1320 feet, more or less to the west line of Section 20, Township 2 North, Range 9 East, S.B.M.;
7. Thence southerly along the west line of said Section 20 and Section 29, Township 1 North, Range 9 East, S.B.M. a distance of 5280 feet, more or less to the north line of the southwest quarter of the southwest quarter of said Section 29;
8. Thence easterly along said north line a distance of 1320 feet, more or less to the east line of the southwest quarter of the southwest quarter of said Section 29;
9. Thence southerly along said east line a distance of 1320 feet, more or less to the north line of Section 32, Township 2 North, Range 9 East, S.B.M.;
10. Thence easterly along said north line a distance of 1320 feet, more or less to the west line of the northeast quarter of said Section 32;
11. Thence southerly along said west line a distance of 2640 feet, more or less to the south line of the northeast quarter of said Section 32;
12. Thence easterly along said south line a distance of 1320 feet, more or less to the east line of the west half of the southeast quarter of said Section 32;
13. Thence southerly along said east line a distance of 2640 feet, more or less to the existing boundary Twentynine Palms Water District, also being the north line of Section 5, Township 1 North, Range 9 East, S.B.M.;
14. Thence easterly along said existing boundary, the north line of said Section 5 and said annexation, a distance of 1320 feet more or less to the northeast corner of said Section 5, same township and range;
15. Thence southerly along said existing boundary, the east line of said Section 5 and annexation to said Twentynine Palms Water District per LAFCO 2717, a distance of 2640 feet, more or less to the west quarter corner of Section 4, being also a point on said annexation per LAFCO 2444;
16. Thence leaving said annexation per LAFCO 2717 easterly along said existing boundary, the quarter section line of said Section 4 and said annexation of LAFCO 2444, a distance of 2640 feet, more or less to the center section corner of said Section 4, being also a point on said annexation per LAFCO 2400;
17. Thence leaving said LAFCO 2444 and continuing northerly along said existing boundary, the quarter section line of said Section 4 and said annexation per LAFCO 2400, a distance of 2640 feet, more or less to the north quarter corner of said Section 4;
18. Thence easterly along said existing boundary, the north lines of said Section 4 and Section 3 and said annexation, a distance of 5280, more or less to the south quarter corner of Section 34, Township 2 North, Range 9 East, San Bernardino Meridian;

19. Thence northerly along said existing boundary, the quarter section line of said Section 34 and said annexation, a distance of 1320 feet, more or less to the north line of the south half of the southeast quarter of said Section;
20. Thence easterly along said existing boundary, said north line and said annexation, a distance of 330 feet, more or less to the east line of the west half of the west half of the southeast quarter of said Section;
21. Thence northerly along said existing boundary, said east line and said annexation, a distance of 1320 feet, more or less to the north line of said southeast quarter;
22. Thence easterly along said existing boundary, said north line and said annexation, a distance of 660 feet, more or less to the west line of east half of the east half of the west half of the northeast quarter of said Section 34;
23. Thence northerly along said existing boundary, said west line and said annexation, a distance of 660 feet, more or less to the north line of the south half of the south half of said northeast quarter of said Section 34;
24. Thence easterly along said existing boundary, said north line and said annexation, a distance of 330 feet, more or less to the west line of the east half of said northeast quarter of said Section 34;
25. Thence northerly along said existing boundary, said west line and said annexation, a distance of 330 feet, more or less to the north line of the south half of the north half of the south half of said northeast quarter of said Section 34;
26. Thence easterly along said existing boundary, said north line and said annexation, a distance of 1320 feet, more or less to the east line of said Section 34;
27. Thence southerly along said existing boundary, said east line and said annexation, a distance of 660 feet, more or less to the south line of the north half of the south half of the south half of said northeast quarter of said Section 34;
28. Thence westerly along said existing boundary, said south line and said annexation, a distance of 660 feet, more or less to the east line of the west half of the east half of said Section 34;
29. Thence southerly along said existing boundary, said east line and said annexation, a distance of 330 feet, more or less to the north line of said southeast quarter of said Section 34;
30. Thence westerly along said existing boundary, said north line and said annexation, a distance of 660 feet, more or less to the east line of the west half of said southeast quarter of said Section;
31. Thence southerly along said existing boundary, said east line and said annexation, a distance of 660 feet, more or less to the north line of the south half of the north half of said southeast quarter of said Section 34;
32. Thence easterly along said existing boundary, said north line and said annexation, a distance of 330 feet, more or less to the east line of the west half of the west half of the east half of said southeast quarter of said Section;

33. Thence southerly along said existing boundary, said east line and said annexation, a distance of 660 feet, more or less to the north line of the south half of said southeast quarter of said Section 34;
34. Thence easterly along said existing boundary, said north line and said annexation, a distance of 990 feet, more or less to the east line of said Section 34;
35. Thence southerly along said existing boundary, said east line and said annexation, a distance of 1320 feet, more or less to the northwest corner of Section 2, Township 1 North, Range 9 East, San Bernardino Meridian;
36. Thence easterly along said existing boundary, said north line and said annexation, a distance of 3300 feet, more or less to west line of the east half of the southwest quarter of the southeast quarter of Section 35, Township 2 North, Range 9 East, San Bernardino Meridian, being also the southwest corner of Document No. 2009-0401685 O. R.;
37. Thence leaving said annexation per LAFCO 2400 and continuing northerly along said existing boundary, said west line and the west line of said Document, a distance of 495 feet, more or less to the northwest corner of said Document, also being the southwest corner of Document No. 1996-0224782 O. R.;
38. Thence continuing northerly along said existing boundary, said west line of the east half of the southwest quarter of the southeast quarter of said Section 35 and the west line of said Document No. 1996-0224782 O. R., a distance of 990 feet, more or less to the northwest corner of said Document;
39. Thence easterly along said existing boundary and the north line of said Document No. 1996-0224782 O. R., a distance of 1320 feet, more or less to the northeast corner of said Document;
40. Thence southerly along said existing boundary and the east line of said Document No. 1996-0224782 O. R., a distance of 990 feet, more or less to the southeast corner of said Document, being also the northeast corner of Document No. 1993-0309906 O. R.;
41. Thence continuing southerly along said existing boundary and the east line of said Document No. 1993-0309906 O. R., a distance of 495 feet, more or less to the southeast corner of said Document, being also a point on the north line of said Section 2, Township 1 North, Range 9 East, San Bernardino Meridian and said proposed annexation dated May 24, 1956;
42. Thence continuing easterly along said existing boundary of LAFCO 2400, said north line and said proposed annexation, a distance of 660 feet, more or less to the northeast corner of Section 2, Township 1 North, Range 9 East, San Bernardino Meridian;
43. Thence southerly along said existing boundary, the east line of said Section 2 and said proposed annexation dated May, 24, 1956, a distance of 1320 feet, more or

- less to the southeast corner of the northeast quarter of the northeast quarter of said Section 2;
44. Thence leaving said proposed annexation westerly along said existing boundary and the south line of said northeast quarter, a distance of 1320 feet, more or less to a point on the east line of the west half of the northeast quarter of said Section 2;
 45. Thence southerly along said existing boundary and said east line, a distance of 660 feet, more or less to a point on said east line of the west half of the northeast quarter of said Section 2, being also a point on said annexation per LAFCO 2400;
 46. Thence continuing southerly along said existing boundary, said east line and said annexation, a distance of 660 feet, more or less to the south line of the northeast quarter of said Section 2;
 47. Thence westerly along said existing boundary, said south line and said annexation, a distance of 1320 feet, more or less to the east line of the west half of said Section 2;
 48. Thence southerly along said existing boundary, said east line and said annexation, a distance of 1320 feet, more or less to the north line of the south half of the southeast quarter of said Section 2;
 49. Thence easterly along said existing boundary, said north line and said annexation, a distance of 660 feet, more or less to the east line of the west half of the west half of said southeast quarter of said Section 2;
 50. Thence southerly along said existing boundary, said east line and said annexation, a distance of 1320 feet, more or less to the south line of said Section 2, being also a point on said annexation per LAFCO 2717;
 51. Thence leaving said annexation per LAFCO 2400 easterly along said existing boundary, said south line of Section 2 and said annexation per LAFCO 2717, a distance of 1980 feet, more or less to the northeast corner of Section 11, same township and range;
 52. Thence southerly along said existing boundary, the east line of said Section 11 and said annexation per LAFCO 2717, a distance of 5280 feet, more or less to the southeast corner of said Section 11, also being a point on said annexation, LAFCO 2444 and the northeast corner of Section 14;
 53. Thence leaving said annexation per LAFCO 2717 and continuing southerly along said existing boundary, said east line of said Section 14 and said annexation per 2444, a distance of 1320 feet, more or less to the south line of the north half of the north half of said Section, being also a point on said annexation per LAFCO 2717;
 54. Thence leaving said annexation per LAFCO 2444 and continuing southerly along said existing boundary, said east line of said Section 14 and Section 23 and said annexation per LAFCO 2717, a distance of 6600 feet, more or less to the east

- quarter corner of Section 23, same township and range, being also a point on annexation 89-1 per LAFCO 2573;
55. Thence leaving said annexation per LAFCO 2717 and continuing southerly along said existing boundary, said east line of said Section 14 and Section 23 and said annexation per LAFCO 2573, a distance of 2640 feet, more or less to the northwest corner of Section 25, same township and range, also being a point on said annexation per LAFCO 2717;
 56. Thence leaving said annexation per LAFCO 2573 easterly along said existing boundary, along the north line of said Section 25 and said annexation per LAFCO 2717, a distance of 5280 feet, more or less to the northeast corner thereof;
 57. Thence southerly along said existing boundary, and the east line of said Section 25 and Section 36 and said annexation per LAFCO 2717, a distance of 10560 feet, more or less to the northwest corner of Section 6, Township 1 South, Range 10 East, San Bernardino Meridian, being also the corner of Township 1 North, Ranges 9 and 10 East, Township 1 South, per Document 92-261137 O. R., recorded June 22, 1992, and said annexation per LAFCO 2805;
 58. Thence leaving said annexation per LAFCO 2717 North 89° 44' East along said existing boundary and the south line of Section 31, Township 1 North, Range 10 East, and the boundary of said Document, and said annexation per LAFCO 2717 a distance of 2658.5 feet;
 59. Thence south along said existing LAFCO 2805 boundary and said Document boundary a distance of 1332.4 feet;
 60. Thence west along said existing LAFCO 2805 boundary and said Document boundary a distance of 1011.3 feet;
 61. Thence continuing south along said existing LAFCO 2805 boundary and said Document boundary a distance of 990 feet;
 62. Thence continuing west along said existing LAFCO 2805 boundary and said Document boundary a distance of 990 feet;
 63. Thence continuing north along said existing LAFCO 2805 boundary and said Document boundary a distance of 330 feet;
 64. Thence continuing west along said existing boundary LAFCO 2805 boundary and said Document boundary a distance of 660 feet, to the east line of said Section 1, Township 1 South, Range 9 East, San Bernardino Meridian, also being a point 1980 feet along said Section line, southerly of said Corner of Townships and Ranges, being also a point on said annexation per LAFCO 2717;
 65. Thence leaving said annexation per LAFCO 2805 and said Document boundary southerly along said existing boundary, said east lines of said Section 1 and Sections 12 and 13, same township and range and said annexation per LAFCO 2717, a distance of 13860 feet, more or less to the southeast corner of said Section 13, Township 1 South, Range 9 East, San Bernardino Meridian;

66. Thence easterly along said existing boundary and the south line of said Section 13 and Sections 14 and said annexation per LAFCO 2717, a distance of 10560 feet, more or less to the southwest corner of said Section 14, same township and range, being also a point on said annexation 89-1 per LAFCO 2573;
67. Thence leaving said annexation per LAFCO 2717 and continuing westerly along said existing boundary, the south line of Section 15 and said annexation 89-1 per LAFCO 2573, a distance of 5280 feet, more or less to the southwest corner of said Section 15;
68. Thence northerly along said existing boundary, the west line of said Section 15 and Section 10 and said annexation 89-1 per LAFCO 2573 a distance of 9900 feet, more or less to the southeast corner of the northeast quarter of the northeast quarter of Section 9, same township and range;
69. Thence leaving said annexation 89-1 westerly along said existing boundary and the south line of said northeast quarter, a distance of 660 feet, more or less to the west line of said northeast quarter;
70. Thence northerly along said existing boundary and said west line, a distance of 660 feet, more or less to the north line of said Section 9, also being a point on said Exhibit A, of approved petition for the incorporation of said Twentynine Palms County Water District, dated April 16, 1954;
71. Thence westerly along said existing boundary, said north line and the boundary of said Exhibit A, a distance of 990 feet, more or less to the northwest corner of the east half of the east half of the northwest quarter of the northeast quarter of said Section 9, being a point on annexation, LAFCO 1384;
72. Thence leaving said Exhibit A and continuing southerly along said existing boundary and the west line of said east half and said annexation, a distance of 1320 feet, more or less to the south line of the northwest quarter of the northeast quarter of said Section 9;
73. Thence continuing westerly along said existing boundary, said south line and said annexation, a distance of 990 feet, more or less to the west line of the northeast quarter of said Section 9;
74. Thence continuing northerly along said existing boundary, said west line and said annexation, a distance of 1320 feet, more or less to the north line of said Section 9, also being a point on said boundary of Exhibit A;
75. Thence leaving said annexation westerly along said existing boundary, said north line and said boundary of Exhibit A, of approved petition for the incorporation of said Twentynine Palms County Water District, dated April 16, 1954, a distance of 2640 feet, more or less to the southwest corner of Section 4, same township and range;
76. Thence northerly along said existing boundary, the west line of said section 4 and said boundary of Exhibit A, a distance of 4125.40 feet, more or less to the

southeast corner of Government Lot 1, per annexation 1961-1 of said Twentynine Palms Water District, Lying within Section 5, Township 1 South, Range 9 East, San Bernardino Meridian;

77. Thence leaving said Exhibit A South 89° 43' 56" West along said existing boundary, the south line of said Government Lot 1 and the south line of Lot 1, Tract No. 2710, a distance of 674 feet, to a point on a parallel line that is distant South 89° 05' West, 242 feet from the east line of said Lot 1, Tract No. 2710;
78. Thence North 0° 01' 20" East along said existing boundary, and said parallel line per said annexation 1961-1 and the boundary of said annexation, a distance of 1147 feet, to a point on the north line of said Lot 1 being South 89° 05' West, distant 242 feet from the northeast corner of said Lot 1, said point also being on the north line of said Section 5 and a point on said boundary of Exhibit A;
79. Thence leaving said annexation 1961-1 westerly along said existing boundary and said north lines Section 5 and Section 6 and along said boundary of Exhibit A, a distance of 9885.94 feet, more or less to the southeast corner of Section 36, Township 1 North, Range 8 East, San Bernardino Meridian;
80. Thence westerly along said existing boundary, the south lines of said Section 36 and Sections 35, 34 and 33, same township and range, and said boundary of Exhibit A, a distance of 21120 feet, more or less to the southwest corner of said Section 33, being also a point on said Water District boundary per annexation No. 1956-1;
81. Thence leaving said boundary of Exhibit A and continuing westerly along said existing boundary, the south lines of Sections 32 and 31, same township and range, and along said annexation a distance of 10560 feet, more or less to the southwest corner of said Section 31;
82. Thence northerly along said existing boundary, the west lines of said Section 31 and Section 30, same township and range, and along said annexation No. 1956 -1 and proposed annexation to said Water District dated September 19, 1962 distance of 10560 feet, more or less to the northwest corner of said Section 30;
83. Thence easterly along said existing boundary, the north line of said Section 30 and along said annexation No. 1956-1 and proposed annexation, a distance of 5280 feet, more or less to the southwest corner of Section 20, same township and range, being also a point on proposed annexation for said Water District dated April 19, 1963;
84. Thence leaving said annexation No. 1956-1 and continuing northerly along said existing boundary and the west line of said Section 20 and said proposed annexation a distance of 5280 to the northwest corner of said Section 20;
85. Thence easterly along said existing boundary, the north line of said Section 20 and along said proposed annexation, and annexation per LAFCO 2400, a distance of

- 2640 feet, more or less to the south quarter corner of Section 17, same township and range, being also a point on said annexation per LAFCO 2400;
86. Thence leaving said proposed annexation and continuing northerly along said existing boundary, the north-south quarter section line of said Section 17 and said annexation per LAFCO 2400, a distance of 5280 to the north quarter corner of said Section 17;
 87. Thence westerly along said existing boundary, the north line of said Section 17 and along said annexation, a distance of 1320 feet, more or less to the west line of the east half of the northwest quarter of said Section 17;
 88. Thence southerly along said existing boundary, said west line and along said annexation, a distance of 330 feet, more or less to the south line of the north half of the north half of the northwest quarter of said Section 17;
 89. Thence westerly along said existing boundary, said south line and along said annexation, LAFCO 2400, a distance of 1320 feet, to the west line of said Section 17;
 90. Thence northerly along said existing boundary, said west line of said Section 17 and Section 8 and along said annexation, a distance of 5610 feet, more or less to the southeast corner of Section 6, same township and range;
 91. Thence westerly along said existing boundary, along the south line of said Section 6, a distance of 5280 feet, more or less to the southwest corner of said Section;
 92. Thence northerly along said existing boundary, said west line of said Section 6 and along said annexation, a distance of 3960 feet, more or less to the north line of the south half of the northwest quarter of said Section 6;
 93. Thence easterly along said existing boundary, said north line and along said annexation, LAFCO 2400, a distance of 330 feet, more or less to the east line of the west half of the west half of the northwest quarter of said Section 6;
 94. Thence southerly along said existing boundary, said east line and along said annexation, a distance of 1320 feet, more or less to the south line of the northwest quarter of said Section 6;
 95. Thence easterly along said existing boundary, said south line and along said annexation, LAFCO 2400, a distance of 1980 feet, more or less to the west line of the east half of the east half of the east half of the northwest quarter of said Section 6;
 96. Thence northerly along said existing boundary, said west line and along said annexation, a distance of 2640 feet, more or less to the north line of said Section 6;
 97. Thence easterly along said existing boundary, said north line and along said annexation, LAFCO 2400, a distance of 330 feet, more or less to the south quarter corner of Section 31, Township 2 North, Range 8 East, San Bernardino Meridian;

98. Thence northerly along said existing boundary, the quarter section line and along said annexation, a distance of 5280 feet, more or less to the south line of said Section 30;
99. Thence westerly along said existing boundary, said south line and along said annexation, LAFCO 2400, a distance of 1320 feet, more or less to the west line of the east half of the west half of Section 30, Township 2 North, Range 8 East, San Bernardino Meridian;
100. Thence northerly along said existing boundary, said west line of the east half of the west half of said Section 30 and Section 19 and along said annexation, a distance of 5940 feet, more or less to the north line of the south half of the south half of said Section 19, also being a point on said annexation per LAFCO 2444;
101. Thence leaving said annexation, LAFCO 2400 and continuing northerly along said existing boundary, said west line of the east half of the west half of said Section 19 and along said annexation, LAFCO 2444, a distance of 4620 feet, more or less to the north line of said Section 19, same township and range;
102. Thence easterly along said existing boundary, said north lines of said Section 19 and Section 20 and along said annexation, a distance of 6600 feet, more or less to the **Point of Beginning**.

Containing 60,755.28 acres, more or less.

This legal description was prepared by me or under my direction.

2/02/2016

James I. Stone

Date

Deputy County Surveyor

PLS 9075, Expiration: March 31, 2016



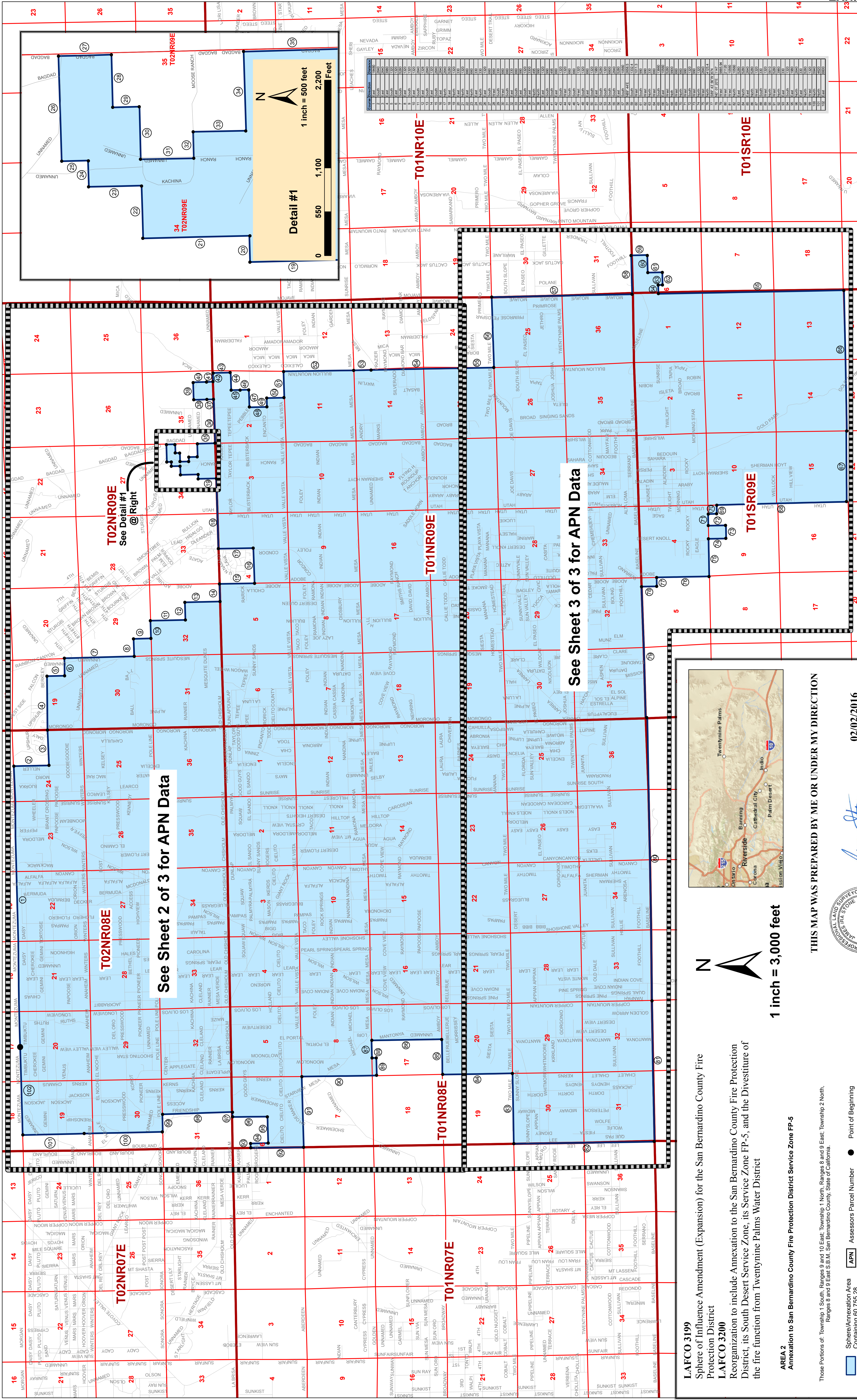

FOR QUESTIONS REGARDING THIS MAP OR TO OBTAIN A COPY OF THIS MAP IN ELECTRONIC FORM, PLEASE
CONTACT LAFCO FOR SAN BERNARDINO COUNTY

THIS MAP WAS PREPARED BY ME OR UNDER MY DIRECTION

Those Portions of: Township 1 South, Ranges 9 and 10 East; Township 1 North, Ranges 8 and 9 East; Township 2 North, Ranges 8 and 9 East S.B.M. San Bernardino County, State of California.

AREA 2
Annexation to San Bernardino County Fire Protection District Service Zone FP-5

LAFCO 3199
Sphere of Influence Amendment (Expansion) for the San Bernardino County Fire Protection District

1 inch = 3,000 feet

02/02/2016

James I. Stone
Deputy County Surveyor

Exp. 3/31/2016

Job Number 00220LF0 - Revised February 2, 2016

FOR QUESTIONS REGARDING THIS MAIL BOX TO OBTAIN A COPY OF THIS MAIL IN ELECTRONIC FORM, PLEASE

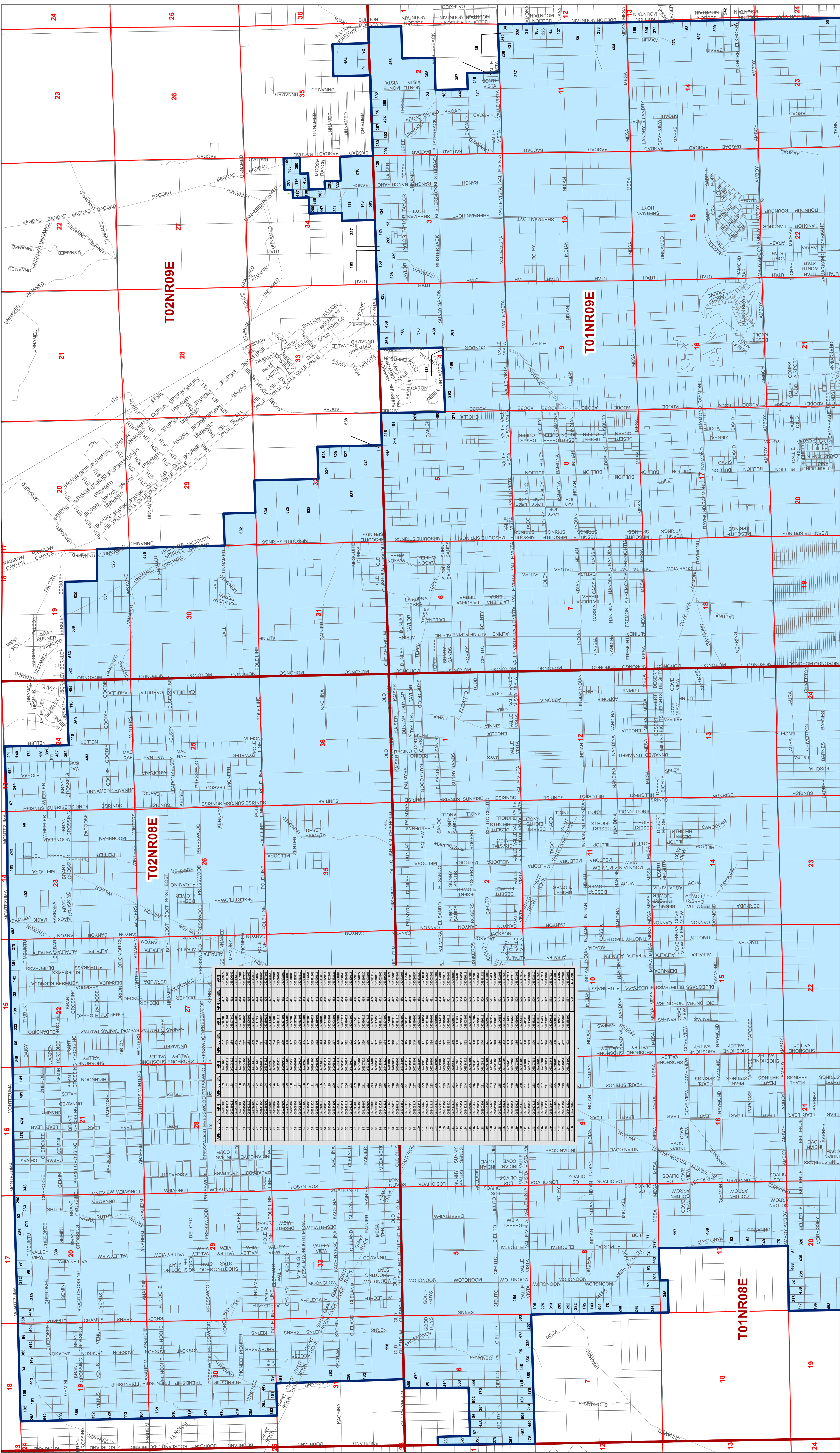

LAFCO 3199
Sphere of Influence Amendment (Expansion) for the San Bernardino
County Fire Protection District

LAFCO 3200
Reorganization to include Annexation to the San Bernardino County
Fire Protection District, its South Desert Service Zone, its Service Zone
FP-5 and the Divestiture of the fire function from Twentynine Palms
Water District

THIS MAP WAS PREPARED BY ME OR UNDER MY DIRECTION

EXHIBIT B-1

James I. Stone
Deputy County Surveyor
PLS 9075

02/02/2016

Date

1 inch = 1,700 feet

0 1,700 3,400 6,800 10,200 13,600 Feet

Those Portions of: Township 1 South, Ranges 9 and 10 East; Township 1 North, Ranges 8 and 9 East; Township 2 North,
Ranges 8 and 9 East S.B.M. San Bernardino County, State of California.

● Sphere/Annexation Area

● Assessor's Parcel Number

● Point of Beginning

● Course Endpoint

● Course Number

APN

Assessor's Parcel Number

Asses

Acres, More or Less

Section Lines

Parcels

LAFCO 3199
Sphere of Influence Amendment (Expansion) for the San Bernardino
County Fire Protection District

LAFCO 3200
Reorganization to include Annexation to the San Bernardino County
Fire Protection District, its South Desert Service Zone, its Service Zone
FP-5 and the Divestiture of the fire function from Twentynine Palms
Water District

THIS MAP WAS PREPARED BY ME OR UNDER MY DIRECTION

EXHIBIT B-1

James I. Stone
Deputy County Surveyor
PLS 9075

02/02/2016

Date

1 inch = 1,700 feet

0 1,700 3,400 6,800 10,200 13,600 Feet

Those Portions of: Township 1 South, Ranges 9 and 10 East; Township 1 North, Ranges 8 and 9 East; Township 2 North,
Ranges 8 and 9 East S.B.M. San Bernardino County, State of California.

● Sphere/Annexation Area

● Assessor's Parcel Number

● Point of Beginning

● Course Endpoint

● Course Number

APN

Assessor's Parcel Number

Asses

Acres, More or Less

Section Lines

Parcels

FOR QUESTIONS REGARDING THIS MAP OR TO OBTAIN A COPY OF THIS MAP IN ELECTRONIC FORM, PLEASE CONTACT
LAFCO FOR SAN BERNARDINO COUNTY

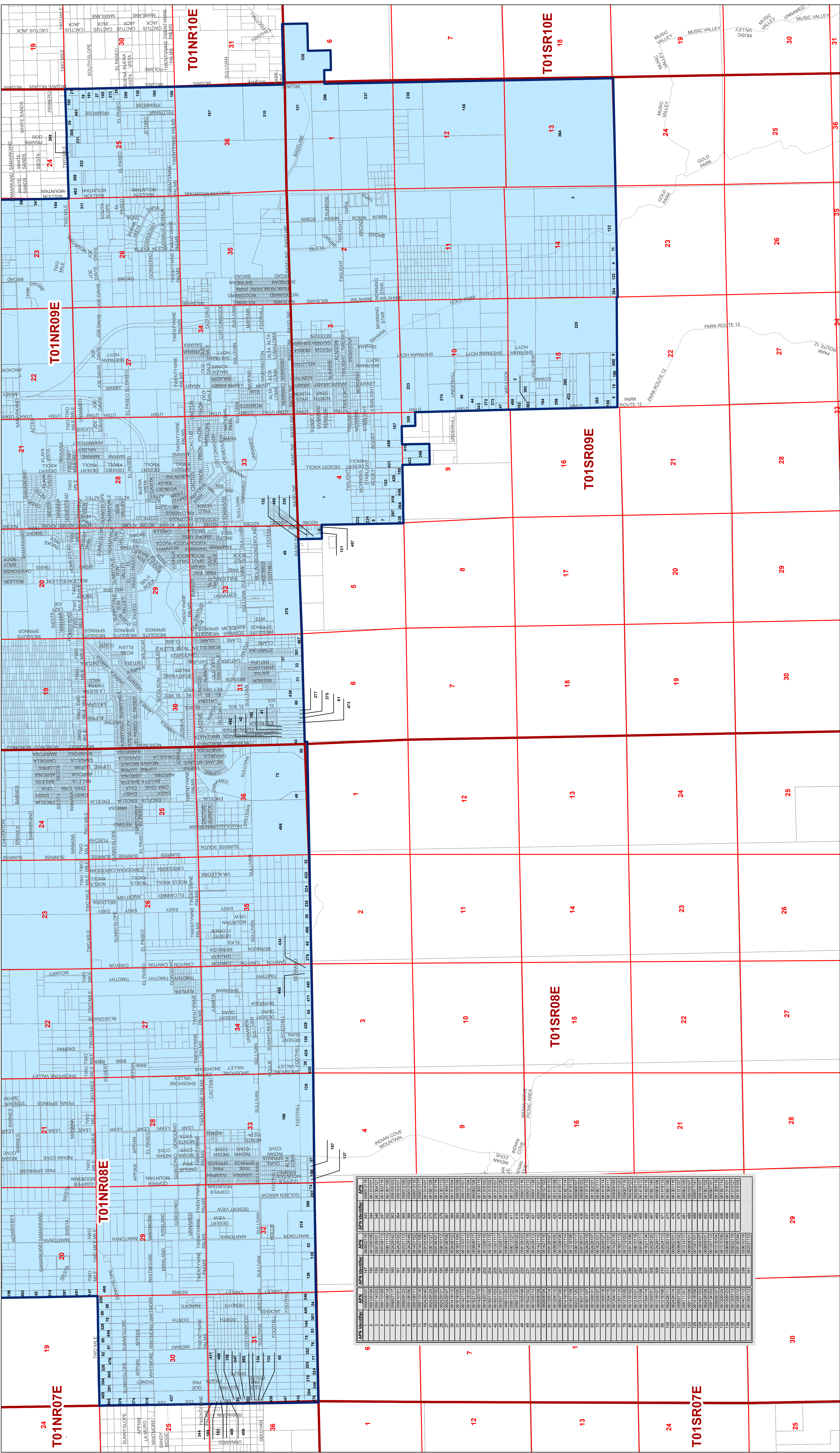

LAFCO 3199
Sphere of Influence Amendment (Expansion) for the San Bernardino County Fire Protection District

LAFCO 3200
Reorganization to include Annexation to the San Bernardino County Fire Protection District, its South Desert Service Zone, its Service Zone FP-5 and the Divestiture of the fire function from Twentynine Palms Water District

AREA 2
Annexation to San Bernardino County Fire Protection District Service Zone FP-5

Those Portions of: Township 1 South, Ranges 9 and 10 East; Township 1 North, Ranges 8 and 9 East; Township 2 North, Ranges 6 and 9 East S.B.M. San Bernardino County, State of California.

- ☒ Sphere/Annexation Area
- ☐ Assessor's Parcel Number
- ☐ Point of Beginning
- ☐ Acres, More or Less
- ☐ Section Lines
- ☐ Parcels
- ☐ Course Number

FOR QUESTIONS REGARDING THIS MAP OR TO OBTAIN A COPY OF THIS MAP IN ELECTRONIC FORM, PLEASE CONTACT
LAFCO FOR SAN BERNARDINO COUNTY



1 inch = 2,000 feet

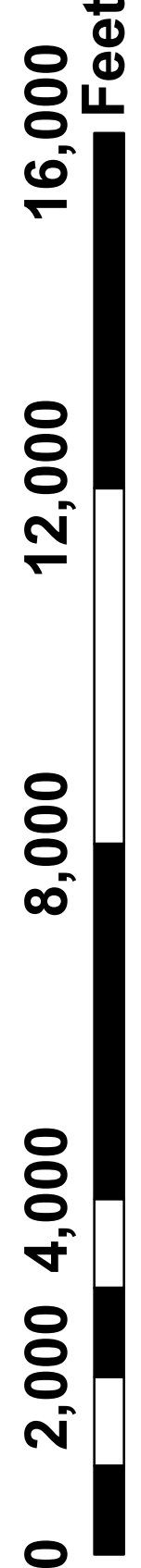

THIS MAP WAS PREPARED BY ME OR UNDER MY DIRECTION



James I. Stone
Deputy County Surveyor
PLS 9075

02/02/2016

Date

Exp. 3/31/2016
Job Number 002201.F0 - Revised February 2, 2016
SHEET 3 OF 3