

May 3, 2012

Mr. Jeff Thachuk, Chairman and CEO.
Coronus Energy Corporation
1100-1200 West 73rd Avenue
Vancouver, B.C., Canada
V6P 6G5

Subject: Cultural Resources Assessment for the Coronus Hesperia West Project, County of San Bernardino, California (LSA Project No. SEP1201)

Dear Mr. Thachuk:

LSA Associates, Inc. (LSA) was retained by Coronus Energy Corporation (Coronus) to conduct a cultural resources assessment to identify potential effects of the proposed development of the 20-acre Hesperia West Solar Project, located in the City of Hesperia, in San Bernardino County (County), California (Figure 1). The project is located in the North ½ of Section 36, Township 4 North, Range 5 West. The project is bounded on the west by Fuente Road, on the north by Fir Street, on the east by Bandicott Street, and on the south by El Centro Street. The study was undertaken in compliance with the California Environmental Quality Act (CEQA). LSA conducted a records search, historical background research, and an archaeological field survey.

CULTURAL RESOURCES ASSESSMENT

Research

The records search, prepared by Robin Laska, Acting Coordinator of the San Bernardino Archaeological Information Center (SBAIC), reported that the project was previously unsurveyed, although 4 area-specific survey reports and 10 general area overviews had been carried out within 0.5-mile of the project.

She reported two linear features – the National Old Trails Road (SBR-2910H) and the Hesperia Pole Line (SBR-4255H) – approximately 0.5-mile to the northwest of the project and 1 historic scatter approximately 0.25-mile northwest of the project (Attachment). Ms. Laska states that there is high sensitivity of the area surrounding the project for both prehistoric and historic archaeological resources, a low sensitivity for built architecture, and an unknown sensitivity for either cultural landscapes or ethnic resources. The project is located within the boundaries of the historic silver Mountain/Oro Grande Mining District, but no contributing elements are located in or adjacent to the project boundaries.

Field Survey

On April 20, 2012, LSA Archaeologist Dr. Frederick Lange surveyed the project site. Vegetation consisted of grasses, creosote, and Joshua trees. Ground visibility was approximately 50 percent. Erosional channels exist on the western and southern boundaries of the project. These channels were also inspected for possible cultural strata or displaced artifacts.

Results

There was relatively little modern trash compared with other urban settings surveyed in the High Desert. During the archaeological field survey, three widely scattered historic isolates (2 punch top cans and 1 solder-top can) were observed; these isolates were not recorded because each was widely (30m+) separated from the others. While the solder-top can is probably associated with the National Old Trails Road that passed approximately 0.5-mile to the northwest of the project, this can and the other two isolates have no associated buried components and no potential to answer any questions important to the history of the area. There were no standing structures or foundations in the project, no prehistoric archaeological resources, no ethnic resources, and no elements suggesting the potential for a cultural landscape.

Report

LSA is providing one electronic copy of the final letter report.

RECOMMENDATIONS

There is little potential for buried cultural resources to be present, and no further archaeological studies or monitoring is recommended.

If previously undocumented cultural resources are identified during any ground-disturbing activities associated with construction of the project, a qualified professional archaeologist should be contacted to assess the nature of the newly discovered resources and recommend treatment per guidelines established by CEQA.

If human remains are encountered at any time during construction or routine maintenance in the project area, State Health and Safety Code Section 7050.5 states that no further disturbance shall occur until the County Coroner has made a determination of origin and disposition pursuant to Public Resources Code Section 5097.98. The County Coroner must be notified of the find immediately. If the remains are determined to be Native American, the County Coroner will notify the Native American Heritage Commission (NAHC), which will determine and notify a Most Likely Descendant (MLD). With the permission of the landowner or his/her authorized representative, the MLD may inspect the site of the discovery. The MLD shall complete the inspection within 48 hours of notification by the NAHC. The MLD may recommend scientific removal and nondestructive analysis of human remains and items associated with Native American burials.

Please feel free to contact LSA with any questions regarding this report (fred.lange@lsa-assoc.com or 951-781-9310).

Sincerely,

LSA ASSOCIATES, INC.

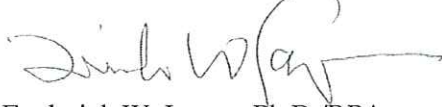
A handwritten signature in black ink, appearing to read "Fred Lange", with a long horizontal flourish extending to the right.

Frederick W. Lange, Ph.D./RPA
Senior Cultural Resources Manager

Attachments: Figure 1. Project Location
Archaeological and Historical Record Search

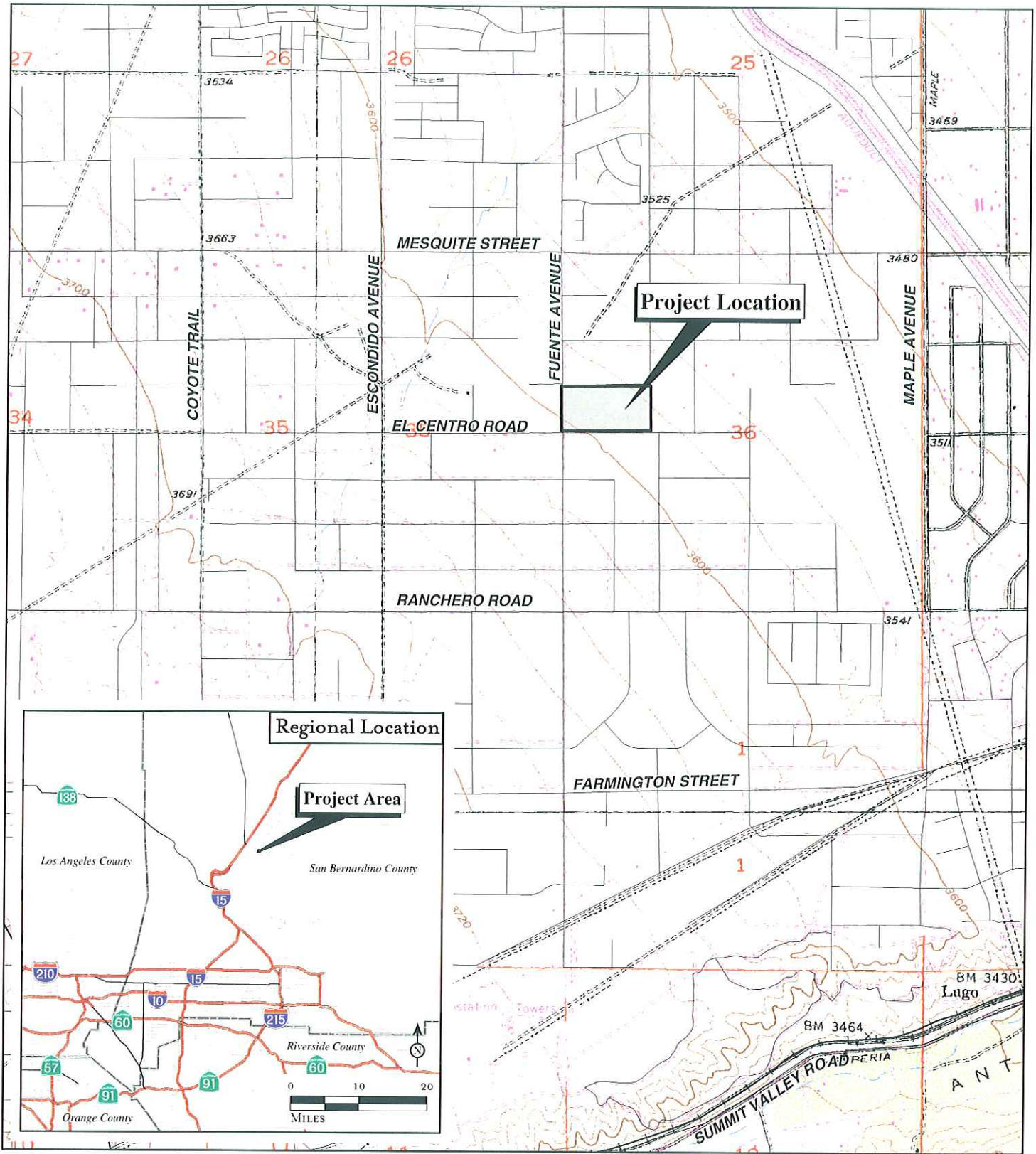
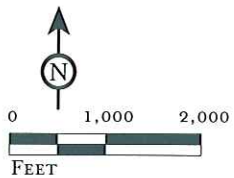

FIGURE 1

LSA



Coronus West Solar (USD)
Cultural Resources Report

ARCHAEOLOGICAL INFORMATION CENTER
San Bernardino County Museum
2024 Orange Tree Lane (909) 307-2669 x 255
Redlands, CA 92374 FAX (909) 307-0689
rlaska@sbcm.sbcounty.gov



San Bernardino
County

26 April 2012

Fred Lange
LSA
1500 Iowa Ave, Ste 200
Riverside, CA 92507

Phone Number: 951-781-9310

HISTORICAL RESOURCES RECORD SEARCH: *Coronus Hesperia West Solar Project*

In response to your request for information dated 18 April 2012, a records search has been conducted for the above project on USGS Hesperia 7.5' quad.

Historical Resources:

Prehistoric Archaeological Resources:

- 0 prehistoric archaeological sites
- 0 pending prehistoric archaeological sites
- 0 prehistoric districts
- 0 prehistoric isolates

Historic Archaeological Resources (sites older than 50 years of age):

- 2 historic archaeological sites
- 0 pending historic archaeological sites
- 0 historic structures
- 0 historic districts
- 0 historic isolates
- 1+ possible historic structure/archaeological site locations determined from historic maps (maps checked): Thompson, 1917/20, 1929; Beasley, 1892; Blackburn, 1932; Perris, 1896; Kremmerer, 1925; AAA-various; USGS Hesperia, 1898/9; US Army Hesperia, 1942.

Cultural Landscapes:

- 0 cultural Landscapes

Ethnic Resources:

- 0 ethnic resources

Heritage Properties (designated by State and Federal commissions):

- 0 National Register Listed Properties
- 1 National Register Eligible Properties
- 0 California Historic Landmarks
- 0 California Points of Historic Interest

PREVIOUS HISTORICAL RESOURCE INVESTIGATIONS:

Historical resource reports for the project area include:

- 4 Area-specific survey reports
- 10 General area overviews

In addition to the Center's historical resources files, the following publications, manuscripts or correspondence also were consulted:

- 1986 Survey of Surveys: A Summary of California's Historical and Architectural Resource Surveys.
- 1988 Five Views: An Ethnic Sites Survey for California.
California Historical Landmarks.
California Points of Historical Interest.
- 2012 Determinations of Eligibility--Records entered into the OHP computer file--received quarterly.
- 2012 Directory of Historic Properties--Records entered into the OHP computer file of historic resources--received quarterly.

SENSITIVITY OF PROJECT AREA FOR HISTORICAL RESOURCES:

Based upon the above information, available historical records and maps, and comparisons with similar environmental localities, the sensitivity assessment for this project area is:

Prehistoric Archaeological Resources	High
Historic Archaeological Resources	High
Historic Resources (built environment)	Low
Cultural Landscapes	Unknown
Ethnic Resources	Unknown

Comments: Potential for Prehistoric Archaeological Resources based on sites found near the APE. Potential for Historic Archaeological Resources based on sites found in the APE and sites associated with the roads shown on historic maps. APE is within the boundaries of the historic Silver Mtn/Oro Grande Mining District.

RECOMMENDATIONS:

In order to minimally comply with CEQA, NEPA and/or Section 106 of the National Historic Preservation Act, a field survey should be conducted by a qualified professional for historical resources within portions of the project area not previously surveyed for such resources. A list of qualified professionals can be found at www.chrisinfo.org.

A CEQA Initial Study of "MAYBE" for potential adverse environmental impact to historical resources is warranted unless it can be documented by a qualified professional that NO resources older than 45 years in age exist on the property. Implementation of the above recommendation(s) will ensure that existing historical resources will be inventoried and evaluated, and that appropriate mitigation measures will be recommended to avoid adverse impacts.

If appropriate mitigation measures are not proposed for significant historical resources within the project area, then subsequent destruction of these resources may violated the California Environmental Quality Act, Nation Environmental Policy Act, National Historic Preservation Act, California codes or various local government ordinances.

If prehistoric or historic artifacts over 50 years in age area encountered during land modification, than activities in the immediate area of the finds should be halted and an on-site inspection should be performed immediately by a qualified archaeologist. This professional will be able to assess the find, determine its significance, and make recommendations for appropriate mitigation measures within the guidelines of the California Environmental Quality Act and/or the Federal National Environmental Policy Act.

If human remains are encountered on the property, then the San Bernardino County Coroner's Office **MUST** be contacted within 24 hours of the find, and all work should be halted until a clearance is given by that office and any other involved agencies. Contact the County Coroner at 175 South Lena Road, San Bernardino, CA 92415-0037 or (909) 387-2543, or (760) 955-8535 in Victorville, or (760) 365-1668 in Yucca Valley or (760) 326-4825 in Needles.

The County of San Bernardino requests that historical resource data and artifacts collected within this project area be permanently curated at a repository within the County. Per a State Historical Resources Commission motion dated 7 Feb 1992, the repository selected should consider 36 CFR 79, Curation of Federally-owned and Administered Archaeological Collection; Final Rule, as published Federal Register, 12 Sept 1990, or a later amended for, for archival collection standards.

If you have any further questions, please, contact me at (909) 307-2669 x 255, Monday through Friday between 8 AM and 4 PM.

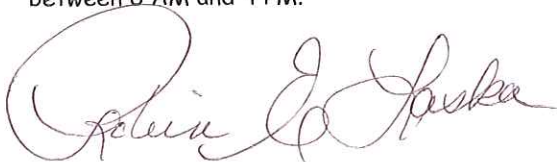

Robin E. Laska
Assistant Center Coordinator